

SCALE 1" = 20' | TWP. 37S., RGE. 41E.

This right of way map when recorded is an instrument of conveyance, transferring in accordance with the Florida Statutes 337.29, all right, title, and interest in the road, street, or highway shown herein, from the Florida Department of Transportation to Martin County.

Recorded in Public Records of Martin County, Florida, this 19 day of May, A.D. 2014, 2014
 in Road Plat Book 1, Page 12
 MAP
 Clerk of the Circuit Court
 Martin County, Florida

RD. ROAD DIV. NO.	STATE	F. A. PROJECT NO.	FISCAL YEAR	SHEET NO.
3	FLA.			

5-723
5-707-A

Map Book 1
Page 12
2 of 2

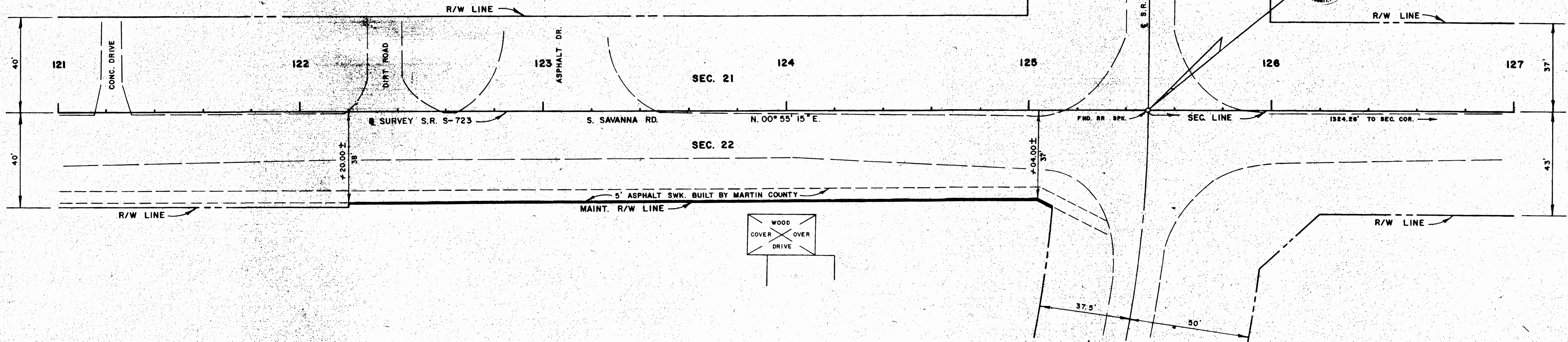

AFFIDAVIT

STATE OF FLORIDA
COUNTY OF MARTIN

BEFORE ME, THE UNDERSIGNED AUTHORITY, DULY AUTHORIZED IN THE STATE AND COUNTY AFORESAID TO ADMINISTER OATHS AND TAKE ACKNOWLEDGMENTS, PERSONALLY APPEARED JACK NOBLE AS COUNTY ADMINISTRATOR AND CLIFFORD RAULERSON AS ROAD SUPERINTENDENT, WHO, AFTER BEING DULY SWORN, DEPOSE AND SAY ON OATH AS FOLLOWS:

1. WE, THE UNDERSIGNED, BEING COUNTY ADMINISTRATOR AND ROAD SUPERINTENDENT, RESPECTIVELY, OF MARTIN COUNTY, FLORIDA, AND AS SUCH DULY QUALIFIED EMPLOYEES OF SAID MARTIN COUNTY, FLORIDA AND WITH THE PROGRAM OF MAINTENANCE AND IMPROVEMENT THEREOF THAT WE HAVE BEEN ASSOCIATED IN PRESENT OR SIMILAR CAPACITY ON ROAD PROGRAMS IN SAID COUNTY FOR A PERIOD IN EXCESS OF 5 YEARS.

2. THAT TO OUR PERSONAL KNOWLEDGE AND OBSERVATION THE ROAD SHOWN AND DESCRIBED AS S.R. 723 LYING BETWEEN S.R. 707 AND S.R. 707-A HAS BEEN MAINTAINED BY THE MARTIN COUNTY ROAD AND BRIDGE DEPARTMENT FOR MORE THAN 14 YEARS. FURTHER THAT THE MAINTENANCE OF SAID S.R. 723 CONSISTS OF MOWING, PERIODIC GRADING AND REPLACING OF MARL BASE MATERIAL.

FURTHER AFFIANTS SAYETH NOT.
THIS 28TH DAY OF MARCH, 1977.

/s/ JACK NOBLE
COUNTY ADMINISTRATOR

/s/ CLIFFORD RAULERSON
ROAD SUPERINTENDENT

SWORN TO AND SUBSCRIBED BEFORE ME THIS 28TH DAY OF MARCH, 1977, BY JACK NOBLE AS COUNTY ADMINISTRATOR AND CLIFFORD RAULERSON SUPERINTENDENT, AT STUART, MARTIN COUNTY, FLORIDA.

WITNESS MY HAND AND OFFICIAL SEAL IN THE COUNTY AND STATE LAST AFORESAID THIS 28TH DAY OF MARCH, 1977.

(NOTARY SEAL) /s/ ALFRED W. HUCKINS
NOTARY PUBLIC, STATE OF FLORIDA AT LARGE
MY COMMISSION EXPIRES: JULY 21, 1978

THIS MAP IS TO SHOW THE RIGHT OF WAY LIMITS MAINTAINED CONTINUOUSLY FOR THE NUMBER OF YEARS AS STATED ABOVE WITHOUT INTERRUPTION OR DISTURBANCE BETWEEN MILE POSTS 1.971 AND 2.025 (S.L.D.)

ACCEPTED FOR FILES AND RECORDED IN THE PUBLIC RECORDS OF MARTIN COUNTY, FLORIDA. THIS 30TH DAY OF MARCH, A.D. 1977. IN RIGHT OF WAY ROAD PLAT BOOK 7, PAGE 13.

/s/ LOUISE V. ISSACS
CLERK OF CIRCUIT COURT OF MARTIN COUNTY, FLORIDA
/s/ BY: PAT GRIFFIN, D.C.

This right of way map when recorded is an instrument of conveyance, transferring in accordance with the Florida Statutes 337.29, all right, title, and interest in the road, street, or highway shown herein, from the Florida Department of Transportation to Martin County.

SOUTH SAVANNA ROAD

STATE OF FLORIDA
DEPARTMENT OF TRANSPORTATION
MAINTENANCE MAP

STATE ROAD NO. S-723 MARTIN COUNTY

DRAWN	STOUT	MAR. 77	BY	DATE
TRACED	STOUT	MAR. 77	BY	DATE
CHECKED	HALL	MAR. 77	BY	DATE
COMPARED			BY	DATE
INDEXED			BY	DATE

ENGINEER OF RIGHT OF WAY
STATE HIGHWAY ENGINEER

REVISION BY DATE

SECTION 89504-2602 SHEET 1 OF 1