

STATE OF FLORIDA
 COUNTY OF PALM BEACH
 THIS INSTRUMENT WAS FILED FOR
 RECORD AT 5:17 PM THIS 8th DAY OF MAY
 1920 AND ONLY RECORDED ON THE 24th
 DAY OF MAY 1920 IN BOOK I. OF
 PLATS ON PAGE 80, RECORD
 VERIFIED.

James J. O'Connell
 CLERK CIRCUIT COURT
 BY: _____
 DEPUTY CLERK

THIS IS A TRUE COPY OF THE ORIGINAL
 PLAT OF RECORD OF "FIRST ADD. TO PORT
 SALERNO", PLAT BOOK 7, PAGE 80, PALM
 BEACH COUNTY, FLORIDA, NOW MARTIN COUNTY.

Fred C. Stafford
 REGISTERED LAND SURVEYOR
 FLORIDA CERTIFICATE NO. 443

**FIRST ADDITION
 TO
 PORT SALERNO
 PALM BEACH COUNTY, FLA.**
 Being a Part of Lots 16 and 17 of Commissioners
 Sub-Division of the Hanson Grant
 Scale 100 FE. To one inch
 CUNNINGHAM & HALLOWES ENGINEERS, FORT PIERCE FLA.
 March 30, 1920.

State of Florida } ss
 County of St. Lucie }
 Personally appeared this day before me F.G. McMullen
 Notary Public State of Florida at Large, A.D. Cunningham, who being
 by me first duly sworn deposes and says that the accompanying
 Plat indicates and is made in accordance with an actual
 Survey of a part of Lots 16 and 17 of Commissioners Sub-
 Division of the Hanson Grant Palm Beach County, Fla.
A.D. Cunningham
 Sworn to and Subscribed before me
 this 27th day of April 1920
F.G. McMullen
 Notary Public State of Florida
 My Commission Expires Feb. 28, 1921

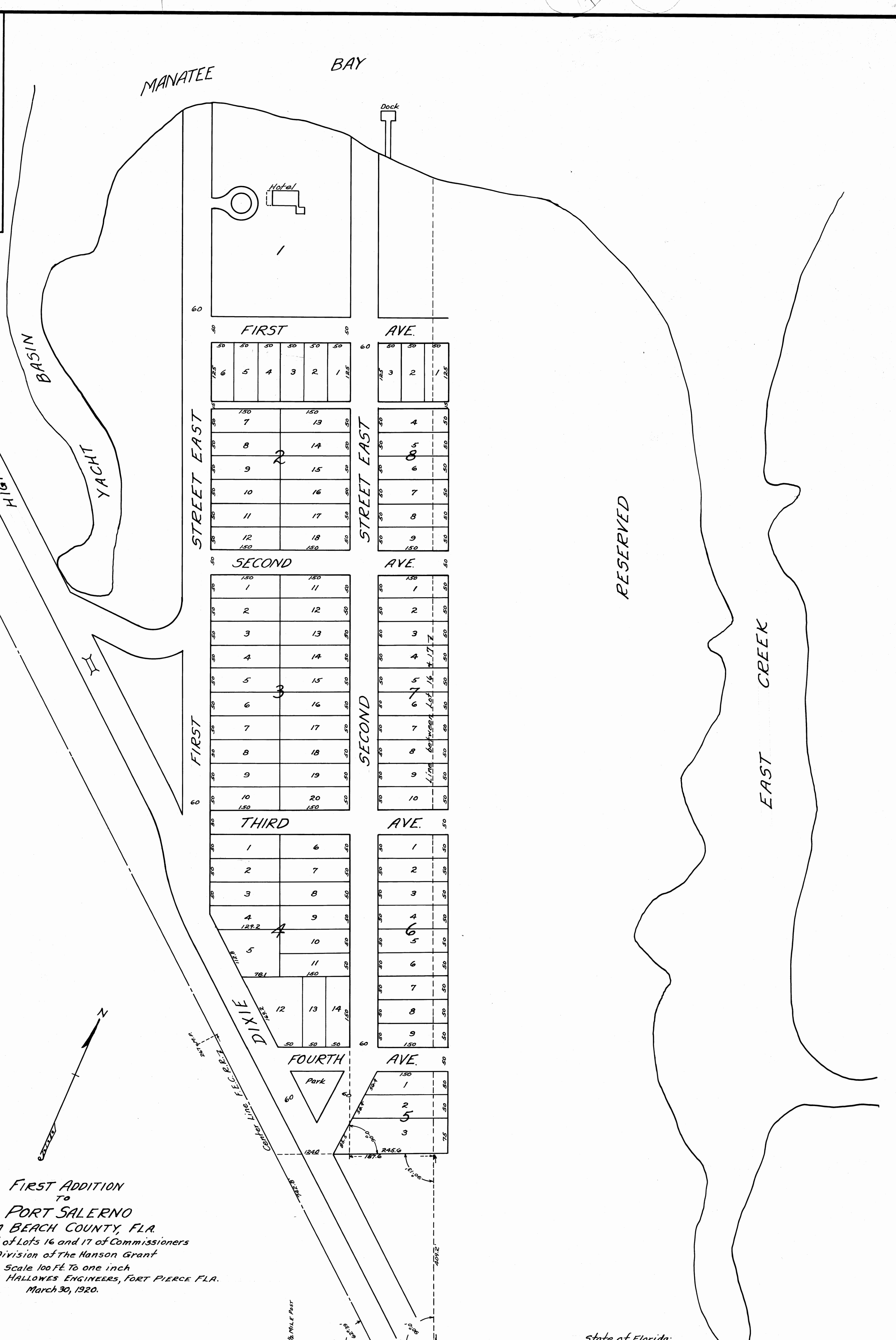

State of Florida:
 County of Palm Beach:
 KNOW ALL MEN BY THESE PRESENTS: That
 I, B.W. Mulford, owner, have caused to be surveyed and platted
 the tract of land shown hereon and described in the certificate of
 the surveyor and made a part hereof, and hereby dedicate to the
 public for the perpetual use thereof, all streets, alleys, avenues
 and the tract designated as a Park, reserving unto myself rever-
 sion and reversions of same when discontinued by law.
B.W. Mulford
 Owner
 Sworn and Subscribed before me this 8 day of May A.D. 1920.
Fred C. Stafford
 Notary Public
 My Commission Expires May 29, 1921