

0.04  
1-80

THIS IS A TRUE COPY OF THE ORIGINAL  
PLAT OF RECORD OF GOMEZ GRANT AND  
JUPITER ISLAND PLAT BOOK 1, PAGE 80, PALM  
BEACH COUNTY, FLORIDA, NOW MARTIN COUNTY.

*Fred A. Stafford*  
REGISTERED LAND SURVEYOR  
FLORIDA CERTIFICATE NO. 443

STATE OF FLORIDA  
COUNTY OF PALM BEACH } 55  
THIS INSTRUMENT WAS FILED  
FOR RECORD THIS 27 DAY OF  
MAY 1910 AND DULY RECORDED  
ON THE 27 DAY OF MAY 1910 IN  
BOOK 1 OF PLATS ON PAGE 80.  
RECORD VERIFIED.

*Dred E. Glenn*  
CLERK CIRCUIT COURT  
BY *D. W. ...*  
DEPUTY CLERK

# GOMEZ GRANT AND JUPITER ISLAND

—THE PROPERTY OF—  
—THE INDIAN RIVER-PINE-APPLE—  
—AND—  
—COCOANUT-GROVE-ASS.—  
—OF—  
—JACKSONVILLE, -FLA.—  
—SCALE 50CH. = 1" —

*Wm Somerville* DEL  
9/26/90

## LEGEND.

Reserve. 100ft. from line of survey along the Atlantic Coast.  
LOTS. on Jupiter Island 5 chains 330' wide Nos. 1 to 214 North to South  
LINES. running East and West TRUE.  
LOTS. on Grant. 10 chains = 660' wide.  
STREETS. 33' wide running S 66° W  
FIRST AVE 60' " " N 24° W  
2<sup>nd</sup> & 3<sup>rd</sup> " 33' " " " " "

Jacksonville, Fla.  
Sept. 28<sup>th</sup> 1893.  
Personally appeared before me  
*J. C. Greeley* President of the Indian River  
Pine Apple and Coconut Grove Association  
and acknowledged the map below to be a  
correct Plat of the property belonging to  
said Association on Indian River

Witness my hand and seal the date  
above written.  
(L.S.) *A. F. Jolly.*  
Notary Public.

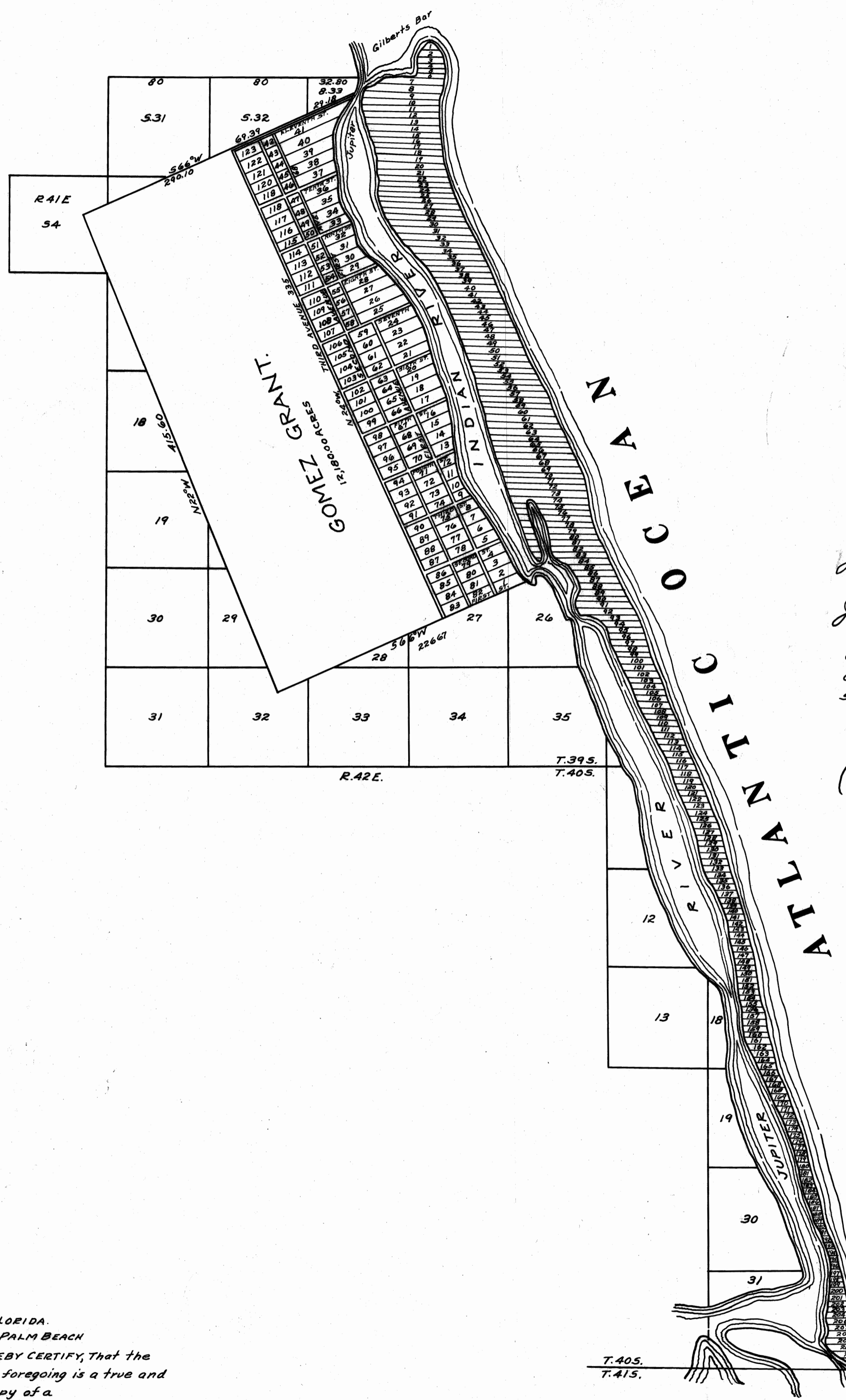

STATE OF FLORIDA.  
COUNTY OF PALM BEACH  
I HEREBY CERTIFY, that the  
above and foregoing is a true and  
correct copy of a  
Map as the same ap-  
pears of record in *Plat Co. Fla.*  
in Book No. *1* of  
*Plat* at page 17  
*Dred E. Glenn*  
Clerk Circuit Court.  
By *D. W. ...*  
May 27-1910

Recorded October 6<sup>th</sup> 1893.  
*A. F. Quimby*  
Clerk Circuit Court.  
(Plat Book A page 17)

Copied by  
*BIDWELL & HOLSTLAW*  
Under direction of  
*C. H. RUGGLES*  
County Engineer

Traced by *R.C.F.* Checked by *C.H.R.*