

"Sandy Depths"
LOUIS J. SCHNEIDER'S SUBDIVISION

A DIVISION OF THE NORTH 1265.05 FEET OF THE SOUTH 2785.05 FEET
OF GOVERNMENT LOT 1, SECTION 19, TWP. 40 N.00 H. RGE. 41 E. 11

MARTIN COUNTY, FLORIDA.

CONDITION OF DOCUMENT
CREDITABLE FOR MICROFILMING

SCALE 1" = 20'

20:1

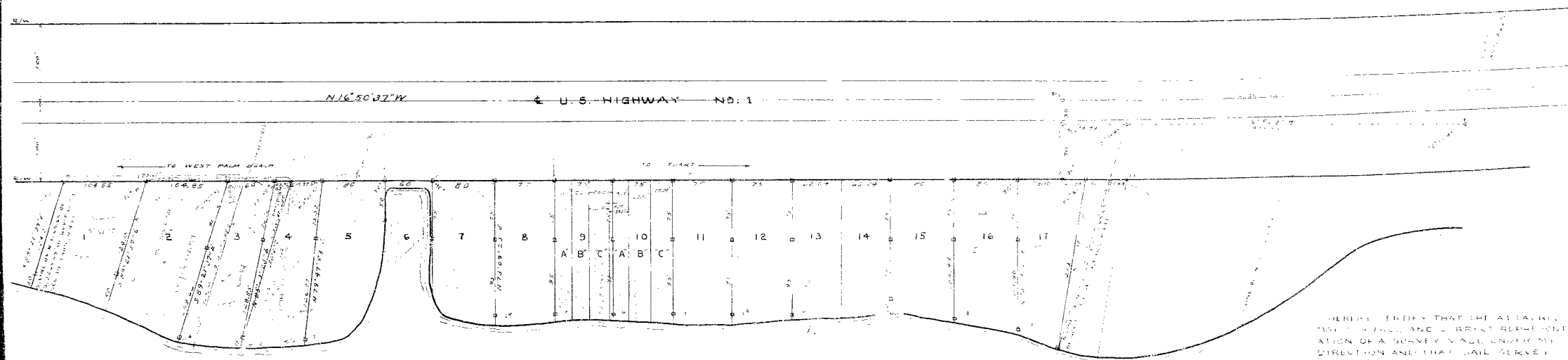

HEREBY CERTIFY THAT THE ABOVE
MAP IS TRUE AND CORRECT REPRESENT
ATION OF A SURVEY MADE UNDER MY
DIRECTION AND THAT I AM A LICENSED
SURVEYOR IN THE STATE OF FLORIDA
AND I BELIEVE TO THE BEST OF MY
KNOWLEDGE AND BELIEF

John C. Brock
J. C. BROCK
REGISTERED PROFESSIONAL SURVEYOR
NO. 12345

FORE SOUND - INTRACOASTAL WATERWAY

STAFFORD C. BROCK
ENGINEERING AND SURVEYING
124 EAST 4th STREET
STUART, FLORIDA
FEB. 5th 1960

CR 138-544 Shows this Survey