

REFERENCE:

F.D.O.T. MAP 89095 - 2412
FLORIDA TURNPIKE MAP SEC. 5A (SH.9 OF 9)
1025867

UTILITIES:

FLORIDA GAS TRANSMISSION
A. T. & T.

PROJECT VICINITY MAP

GENERAL NOTES:

- BEARINGS ARE REFERENCED TO THE BEARING N 16°22'13"W FOR THE CENTERLINE OF STATE ROAD No 9 (I-95) AS SHOWN ON FLORIDA DEPARTMENT OF TRANSPORTATION RIGHT OF WAY MAP SECTION 89095 - 2412 BETWEEN STATIONS 1110+73.33 AND 1117+57.92
- PROPERTY BOUNDARIES DETERMINED FROM RECORD TITLE.
- UNDERGROUND FOUNDATION ENCROACHMENTS NOT LOCATED.
- RIGHT OF WAY MONUMENTS TO BE SET AFTER PROJECT CONSTRUCTION IS COMPLETE.
- ONLY FIXED IMPROVEMENTS PERTINENT TO THE SURVEY ARE SHOWN. FIXED INTERIOR IMPROVEMENT NOT LOCATED.

I-95 CURVE DATA
 P.I. STA. 1204+47.21
 $\Delta = 74^\circ 20' 42''$ LT.
 $D = 0^\circ 30' 00''$
 $T = 8689.29'$
 $L = 14868.98'$
 $R = 11459.16'$
 PC. STA. 1117+57.92
 PT. STA. 1266+26.90

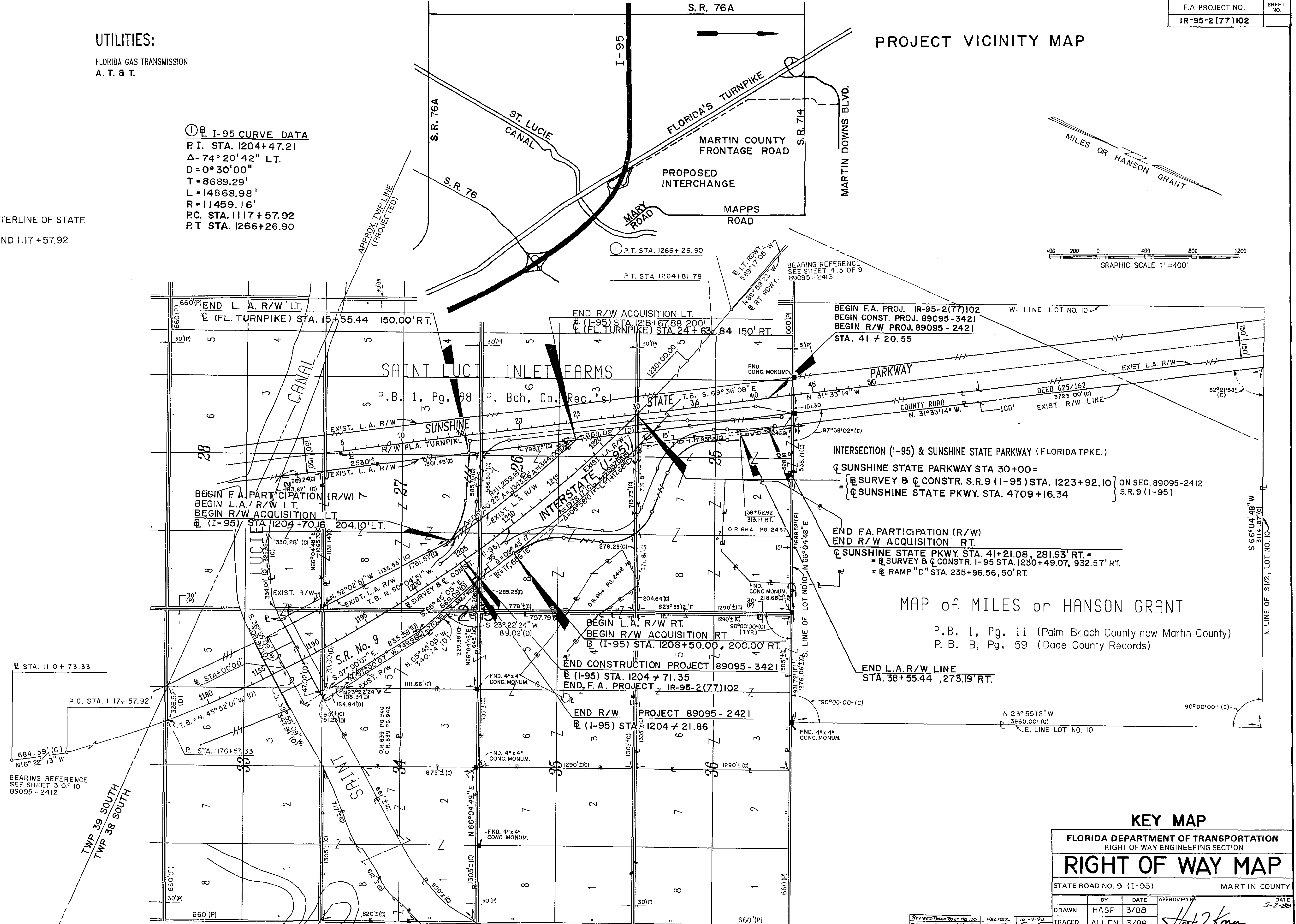
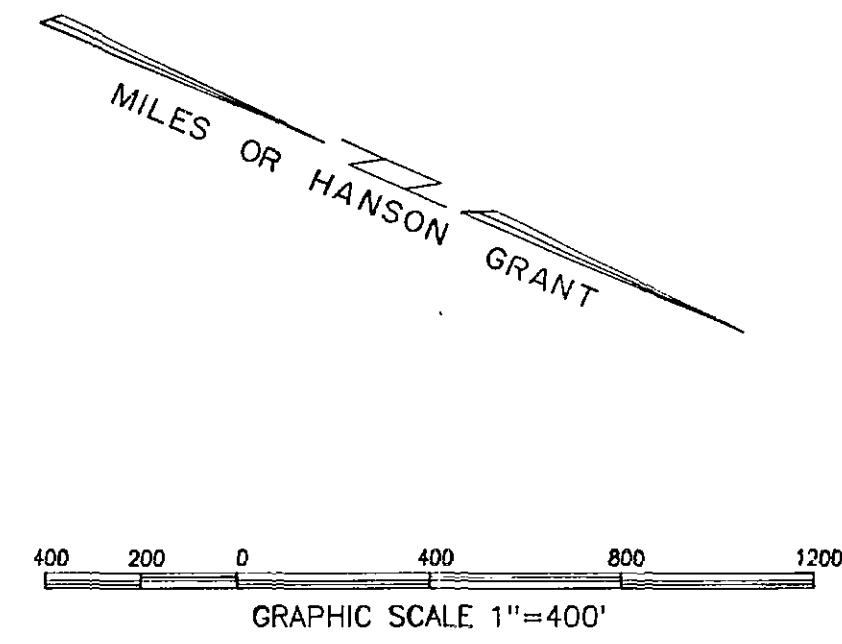

CERTIFICATION TO THE FLORIDA DEPARTMENT OF TRANSPORTATION

- THIS CERTIFICATION IS MADE EXCLUSIVELY TO THE FLORIDA DEPARTMENT OF TRANSPORTATION FOR THE SPECIFIC PURPOSE OF APPRAISAL, ACQUISITION AND MONUMENTATION OF RIGHT OF WAY FOR TRANSPORTATION PROJECTS.
- NO RESPONSIBILITY OR LIABILITY IS ASSUMED BY THE UNDERSIGNED SURVEYOR FOR USE OF THIS MAP OF SURVEY FOR ANY PURPOSE OTHER THAN THAT ABOVE STATED OR FOR USE BY ANY PERSON OR ENTITY OTHER THAN THE FLORIDA DEPARTMENT OF TRANSPORTATION.
- THE POSITIONS OF ALL PHYSICAL OBJECTS SHOWN UPON THIS DRAWING ARE TAKEN FROM A FIELD SURVEY PREPARED UNDER THE DIRECTION OF JAMES C. JACKSON, FLORIDA REGISTERED LAND SURVEYOR No. 4356, SAID SURVEY BEING COMPLETED IN MARCH, 1987, AND CERTIFIED IN FIELD BOOK No. 1025867. THE UNDERSIGNED SURVEYOR ASSUMES NO LIABILITY FOR THE ACCURACY OR COMPLETENESS OF SAID FIELD SURVEY.
- SPECIAL CONDITIONS AND/OR CIRCUMSTANCES AFFECTING THIS MAP ARE LISTED UNDER "GENERAL NOTES" ON THIS SHEET.

SUBJECT TO THE ABOVE EXCLUSIONS, RESERVATIONS, CONDITIONS AND RESTRICTIONS, I HEREBY CERTIFY THAT THIS MAP, CONSISTING OF SHEETS 1 THROUGH 3, IS TRUE, ACCURATE AND COMPLETE TO THE BEST OF MY KNOWLEDGE AND BELIEF. I FURTHER CERTIFY THAT SAID MAP IS IN COMPLIANCE WITH THE MINIMUM TECHNICAL STANDARDS FOR SPECIFIC PURPOSE SURVEYS AS SET FORTH BY THE FLORIDA BOARD OF LAND SURVEYORS, PURSUANT TO SECTION 472.027, FLORIDA STATUTES.

HORST J. KORN
 Florida Registered Land Surveyor No. 3509
 Fort Lauderdale, Florida

Date:

"NOT VALID UNLESS EMBOSSED"

MAP of MILES or HANSON GRANT
 P.B. 1, Pg. 11 (Palm Beach County now Martin County)
 P.B. B, Pg. 59 (Dade County Records)

KEY MAP

FLORIDA DEPARTMENT OF TRANSPORTATION RIGHT OF WAY ENGINEERING SECTION			
RIGHT OF WAY MAP			
STATE ROAD NO. 9 (I-95)		MARTIN COUNTY	
DRAWN	HASP	DATE	3/88
TRACED	ALLEN	DATE	3/88
CHECKED	JACKSON	DATE	3/88
MAPS PREPARED BY KEITH & SCHNARS, P.A.		FIELD BOOK NOS. 1025867, 1003041	
W.P.I. NO. 4146416		SCALE 1" = 400'	
SECTION 89095-2421		SHEET 1 OF 3	

REVISED FROM	DATE	BY
REMOVED 30' R/W VACATED	9-21-90	WELMER
ADD. F.P.L. EASE.	09-20-90	E. WATSON
REV. END L.A. LOC.	9-18-90	WELMER
REMOVED 4" R/W	9-17-90	JACKSON
REV. PAR. 100	09-13-90	SMITH
REV. PAR. 100 (N. R/W)	07-08-90	CORREIA/WAT
REV. PAR. 100, 800, 801	6-16-89	WILSON
REV. PAR. 100 (NORTH R/W)	10/24/88	CORREIA

