

FED. ROAD DIV. NO.	STATE	F A PROJECT NO.	FISCAL YEAR	SHEET NO.
2	FLA.			

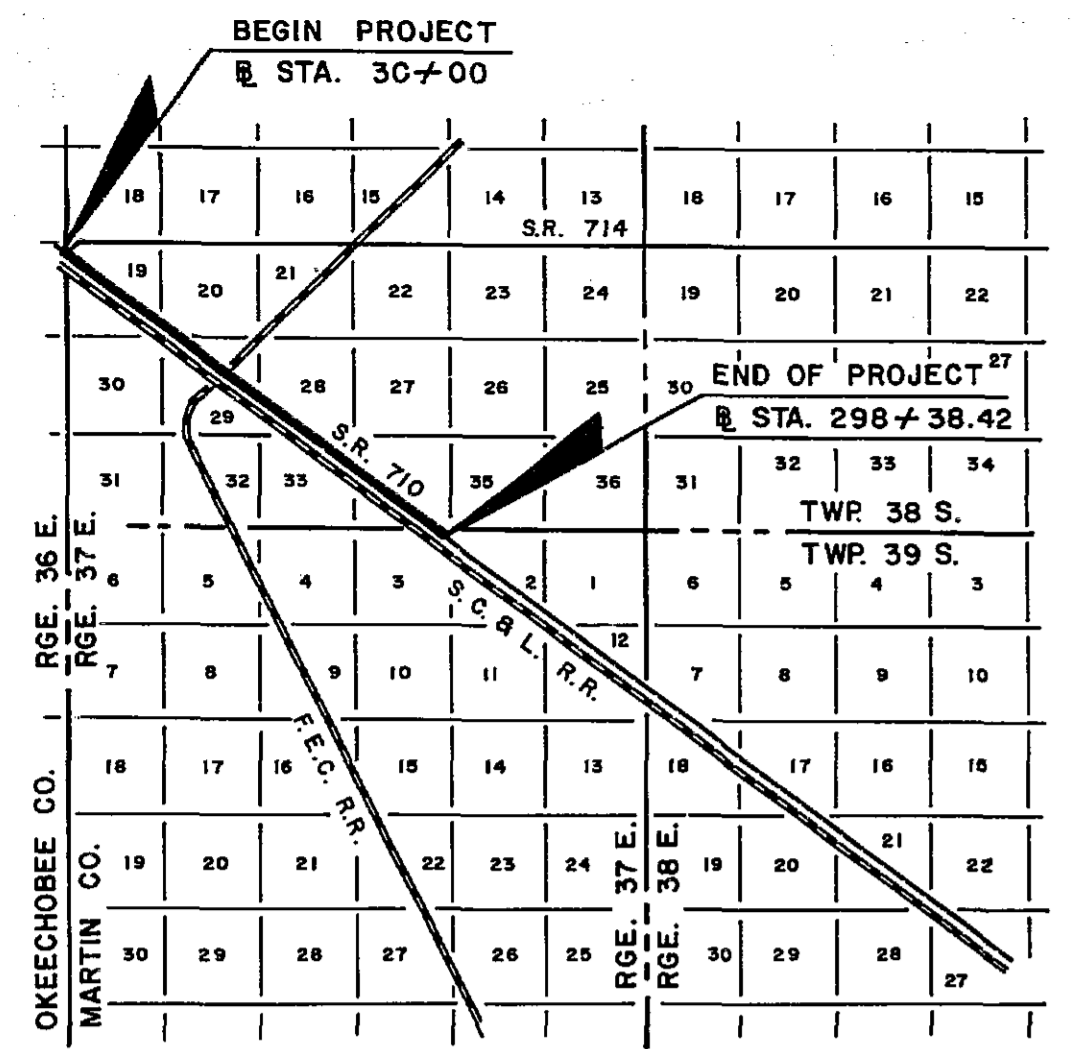

LOCATION SKETCH
"NOT TO SCALE"

BEARING REFERENCE
89090-2506 S.R. 714

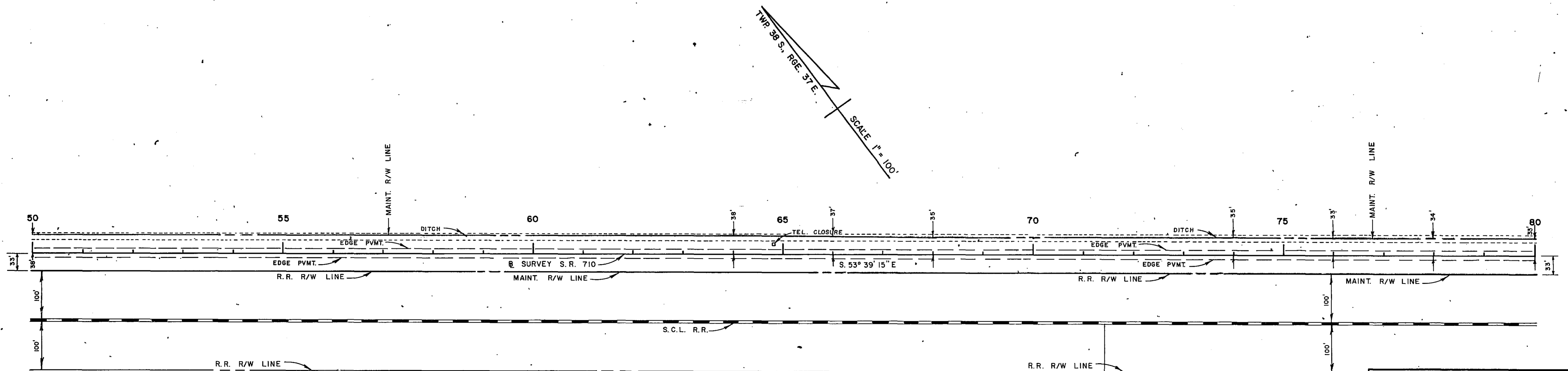
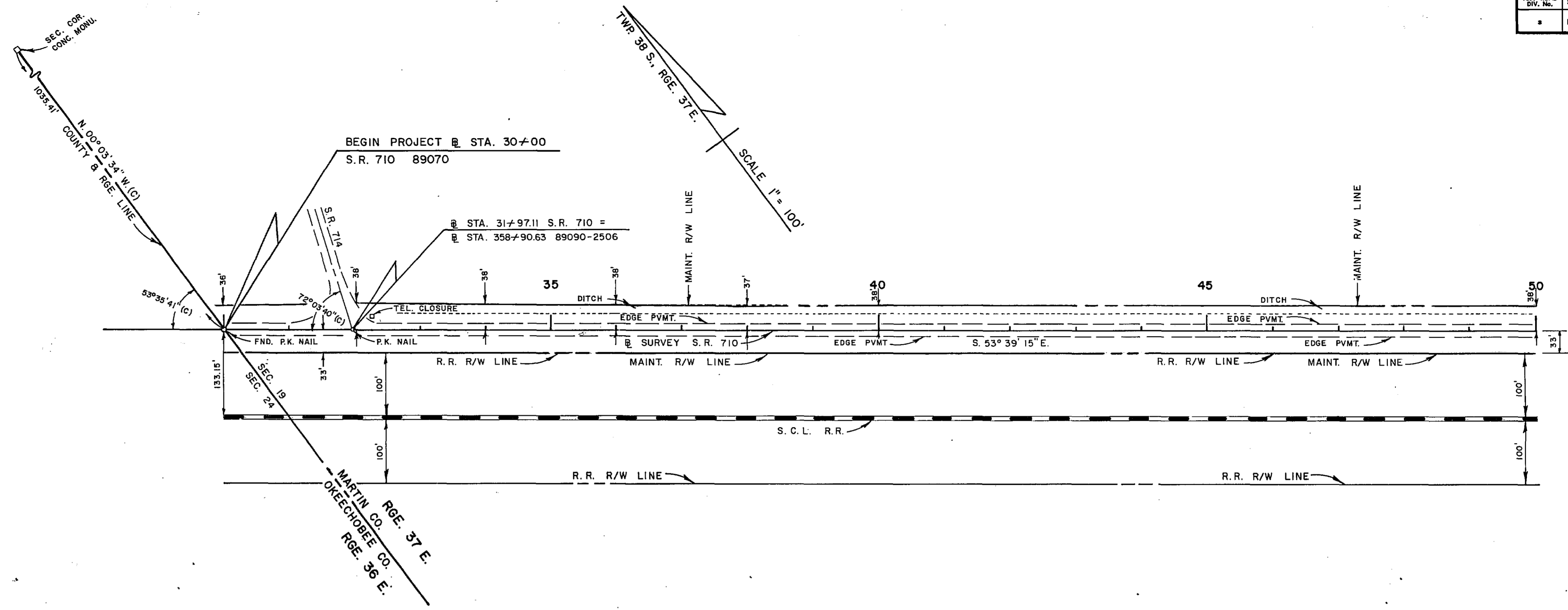

◇ @ STA. 71+42.7
R.R. MILE POST 521

STATE OF FLORIDA DEPARTMENT OF TRANSPORTATION				
MAINTENANCE MAP				
STATE ROAD NO. 710		MARTIN COUNTY		
BY	DATE	APPROVED BY	DATE	
STOUT	DEC. 75	<i>[Signature]</i>		
TRACED	STOUT	DEC. 75	DISTRICT ENGINEER	
CHECKED	HALL	JAN. 76	ENGINEER OF RIGHT OF WAY	
COMPARED				
INDEXED				
REVISION	BY	DATE	SECTION 89070-2508 SHEET 1 OF 5	

ALL R.R. M. Post Sta. 714	57000	7-30-76
---------------------------	-------	---------

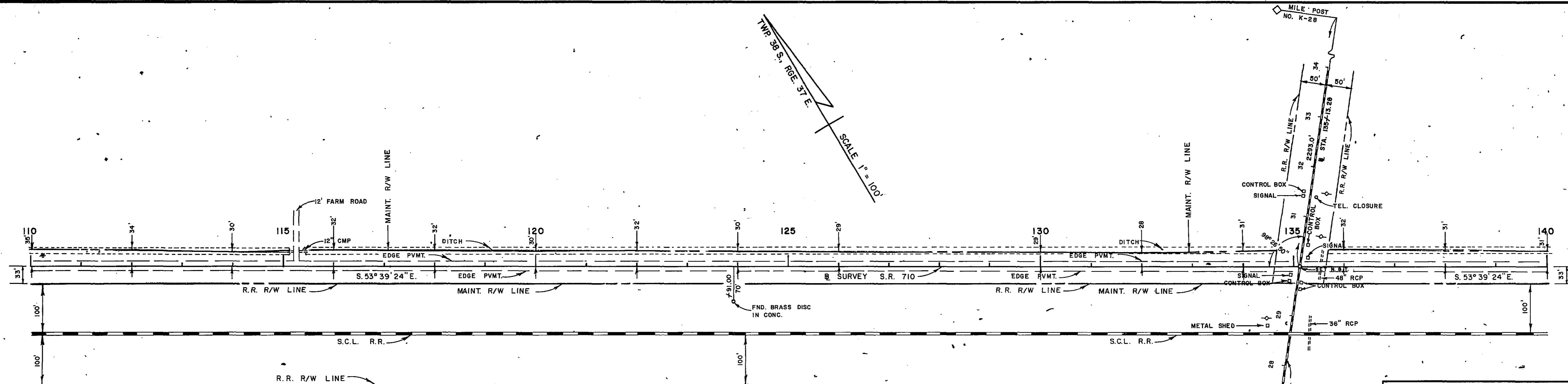
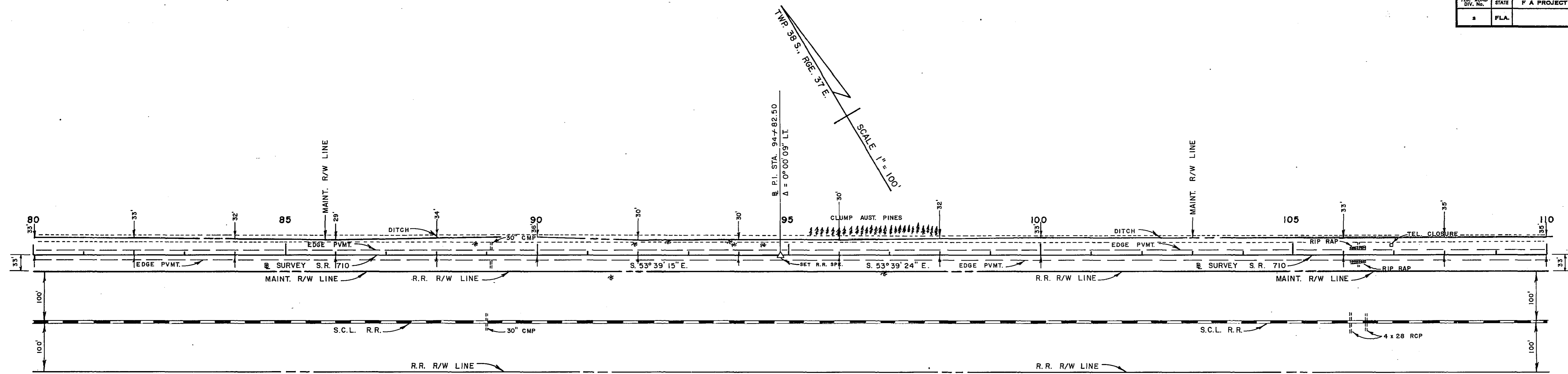

STATE OF FLORIDA DEPARTMENT OF TRANSPORTATION			
MAINTENANCE MAP			
STATE ROAD No. 710		MARTIN COUNTY	
DRAWN	BY	DATE	APPROVED BY
STOUT	STOUT	12-17-75	<i>M. D. Stout</i>
TRACED	STOUT	12-17-75	DISTRICT ENGINEER
CHECKED	HALL	JAN. 76	ENGINEER OF RIGHT OF WAY
COMPARED			
INDEXED			
REVISION	BY	DATE	
1. Add P.E.S. M. Post	STOUT	1-30-76	

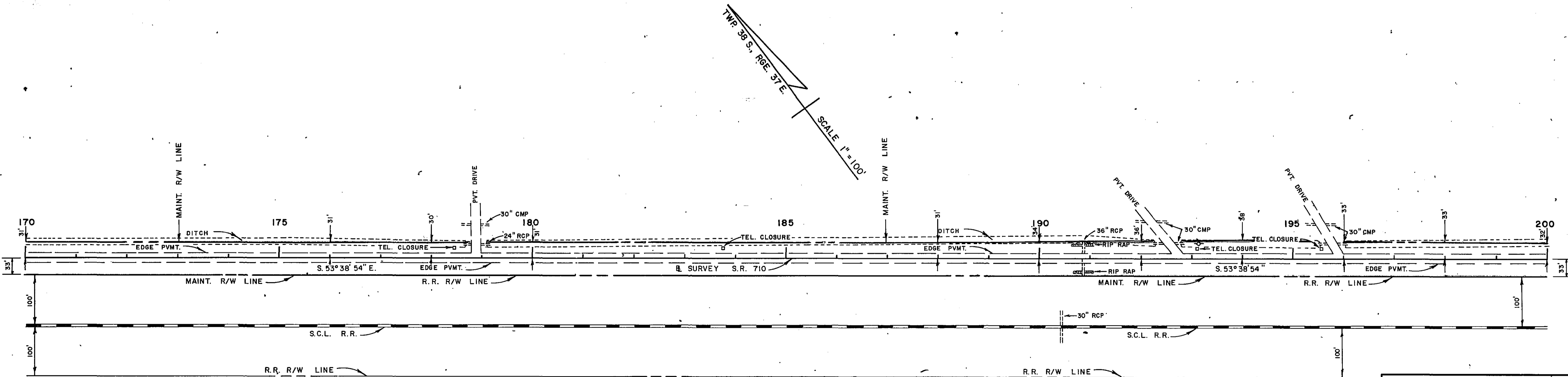
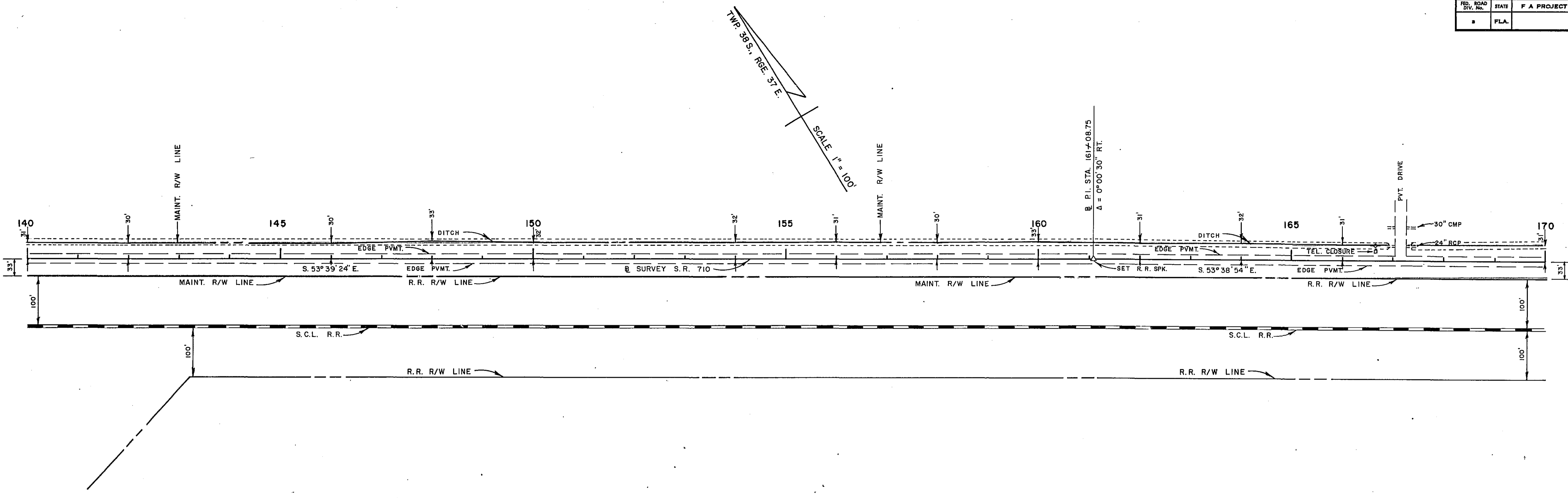

STATE OF FLORIDA
DEPARTMENT OF TRANSPORTATION
MAINTENANCE MAP

STATE ROAD NO. 710 MARTIN COUNTY

DRAWN	BY	DATE	APPROVED BY	DATE
TRACED	STOUT	12-19-75	<i>[Signature]</i>	
CHECKED	HALL	JAN. 76		
COMPARED				
INDEXED				

SECTION 89070-2508 SHEET 3 OF 5
B.I. NO. 416143

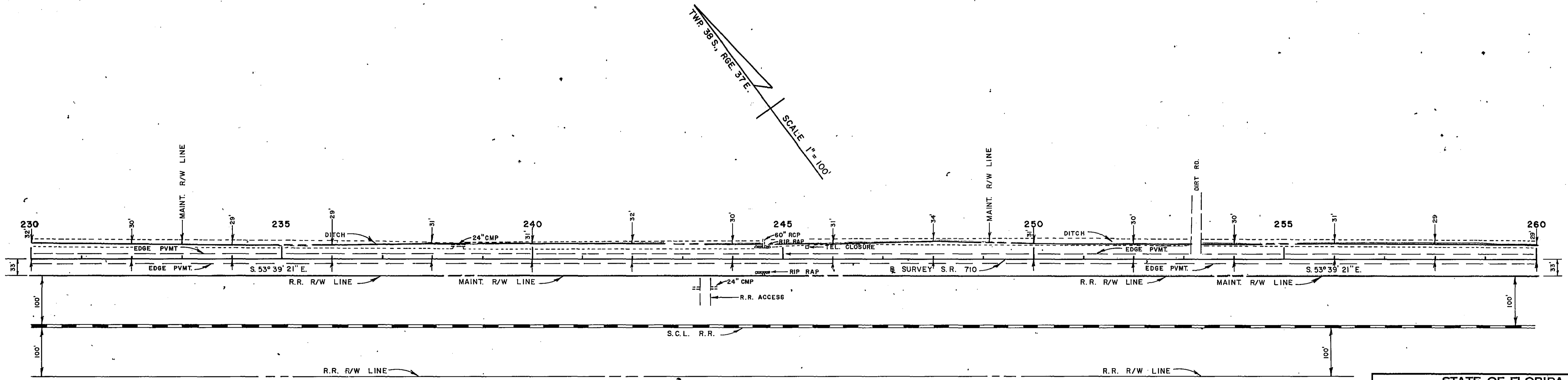
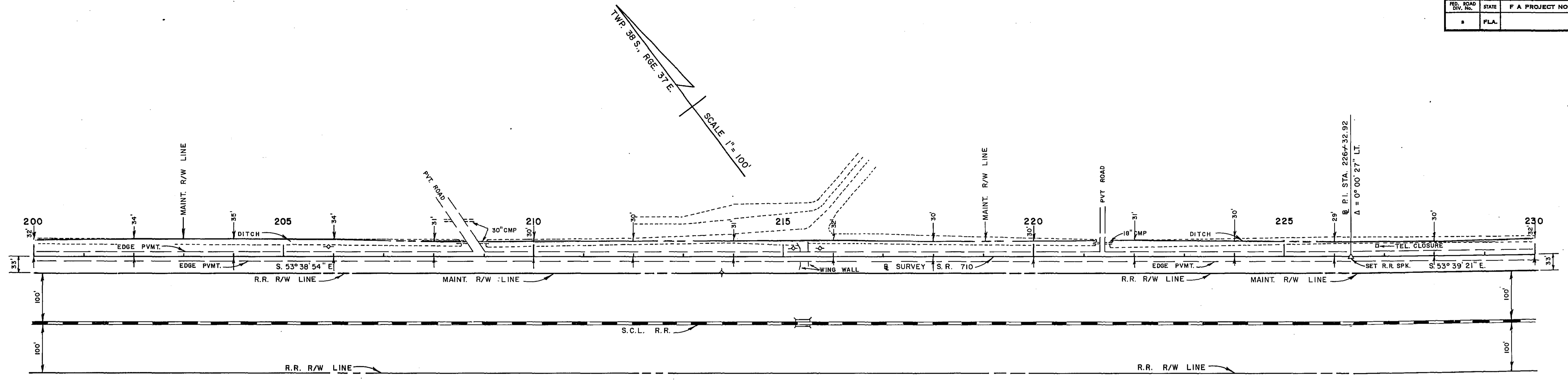

STATE OF FLORIDA
DEPARTMENT OF TRANSPORTATION
MAINTENANCE MAP

STATE ROAD No. 710 MARTIN COUNTY

DRAWN	BY	DATE	APPROVED BY	DATE
STOUT	STOUT	12-22-75	<i>W.D. Simpson</i>	
TRACED	STOUT	12-22-75		
CHECKED	HALL	JAN. 76		
COMPARED				
INDEXED				

ENGINEER OF RIGHT OF WAY
STATE HIGHWAY ENGINEER

REVISION	BY	DATE

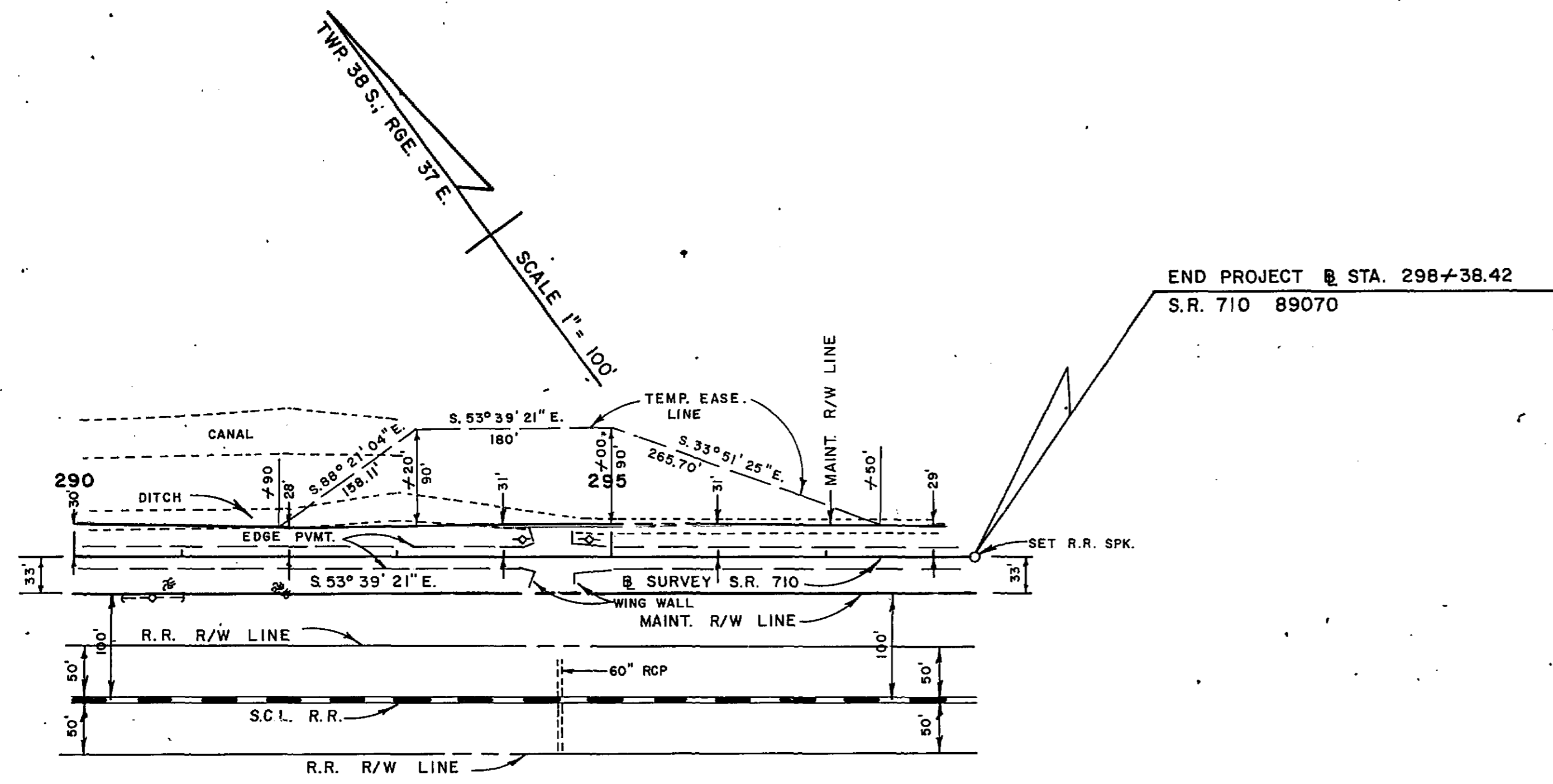
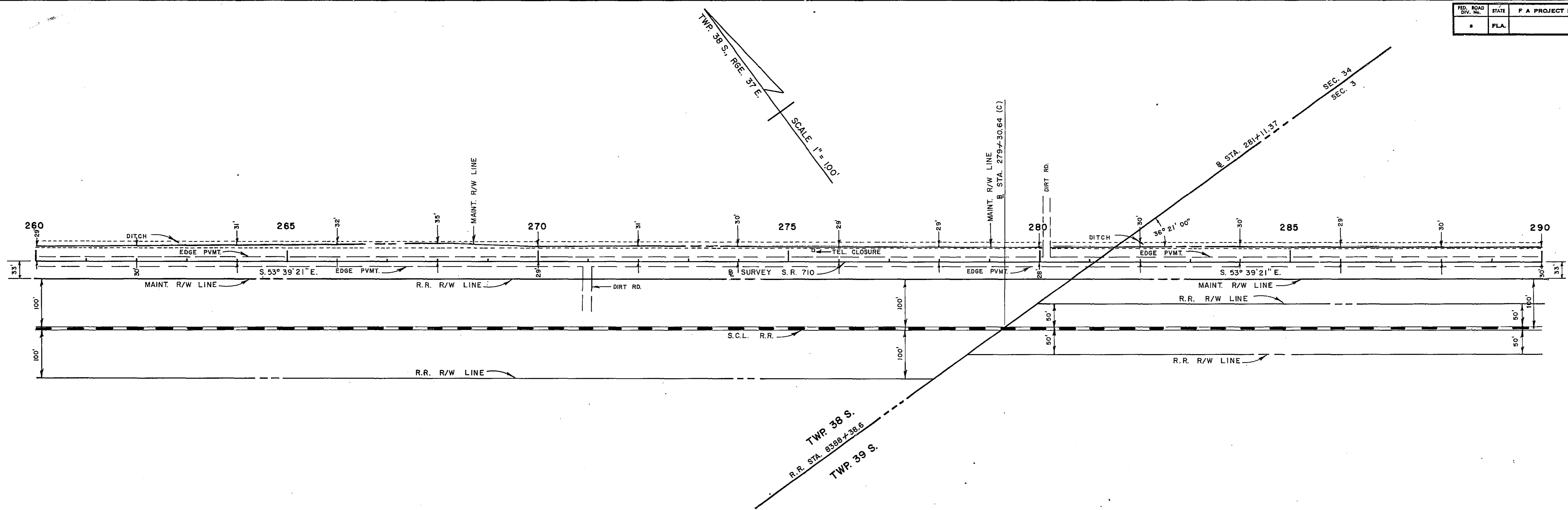

THIS IS TO CERTIFY THAT THE WITHIN AND ATTACHED SHEETS NUMBERED ONE (1) THRU FIVE (5) CONSTITUTES A TRUE COPY OF THE OFFICIAL RIGHT OF WAY MAP SHOWING LOCATION AND SURVEY BY THE DEPT. OF TRANSPORTATION OF FLORIDA FOR A PORTION OF STATE ROAD 710 DESIGNATED AS SECTION 89070 IN MARTIN COUNTY, FLORIDA.

THE PROPERTY OUTLINED IN RED INK ON THE SAID SHEETS HAS BEEN VESTED IN THE DEPT. OF TRANSPORTATION OF FLORIDA, PURSUANT TO THE PROVISIONS OF SECTION 341.59 FLORIDA STATUTES OF 1951 AND SECTION 337.31 FLORIDA STATUTES OF 1955, AND/OR UNDER FORMAL CONVEYANCE AND OTHER INSTRUMENTS.

IN WITNESS WHEREOF WE HAVE HEREUNTO SET OUR HANDS AND AFFIXED THE SEAL OF THE DEPT. OF TRANSPORTATION OF FLORIDA, AT TALLAHASSEE, FLORIDA THIS _____ DAY OF _____ AD 19_____

SECRETARY OF TRANSPORTATION
STATE OF FLORIDA DEPARTMENT
OF TRANSPORTATION

EXECUTIVE SECRETARY

THIS IS TO CERTIFY THAT THE RIGHT OF WAY LIMITS AS SHOWN ON THIS MAP HAVE BEEN MAINTAINED CONTINUOUSLY FOR FOUR (4) YEARS IMMEDIATELY PAST WITHOUT INTERRUPTION OR DISTURBANCE BETWEEN MILE POSTS 0.000 AND 5.100, (S.L.D.)

J. R. [Signature]
MAINTENANCE ENGINEER

ACCEPTED FOR FILES AND RECORDED IN THE PUBLIC RECORDS OF MARTIN COUNTY, FLORIDA, THIS 24th DAY OF AUGUST 1976 IN RIGHT OF WAY PLAT BOOK 7 PAGE 4

CLERK OF CIRCUIT COURT OF MARTIN COUNTY FLORIDA

STATE OF FLORIDA DEPARTMENT OF TRANSPORTATION MAINTENANCE MAP			
STATE ROAD No. 710		MARTIN COUNTY	
BY	DATE	APPROVED BY	DATE
DRAWN	STOUT 12-22-75	<i>[Signature]</i>	
TRACED	STOUT 12-22-75		
CHECKED	HALL JAN. 76		
COMPARED			
INDEXED			
CHG. R/W JOB NO.	ROTHERMEL 12-20-76	SECTION 89070-(2508) 2515 SHEET 5 OF 5	
REVISION	BY	DATE	