

THIS IS TO CERTIFY THAT THE WITHIN AND ATTACHED SHEETS NUMBERED
1 TO 2, INCLUSIVE, CONSTITUTE A TRUE COPY OF
THE OFFICIAL RIGHT OF WAY MAP SHOWING LOCATION AND SURVEY BY THE
STATE OF FLORIDA DEPARTMENT OF TRANSPORTATION FOR A PORTION OF
STATE ROAD 707, DESIGNATED AS SECTION 89030-
IN MARTIN COUNTY, FLORIDA.

THE PROPERTY OUTLINED IN RED INK, AND LABELED MAINT. R/W LINE ON
THE SAID SHEETS HAS BEEN VESTED IN THE STATE OF FLORIDA DEPARTMENT
OF TRANSPORTATION, PURSUANT TO THE PROVISIONS OF SECTION 341.59 FLORIDA
STATUTES OF 1951, SECTION 337.31 FLORIDA STATUTES OF 1955 AND SECTION
95.361 FLORIDA STATUTES OF 1974, AND/OR UNDER FORMAL CONVEYANCE AND
OTHER INSTRUMENTS.

IN WITNESS WHEREOF, WE HAVE HEREUNTO SET OUR HANDS AND AFFIXED
THE SEAL OF THE STATE OF FLORIDA DEPARTMENT OF TRANSPORTATION, AT
TALLAHASSEE, FLORIDA, THIS 17th DAY OF Nov., A.D. 1977

151 Tom Webb Jr.
SECRETARY OF TRANSPORTATION,
STATE OF FLORIDA DEPARTMENT
OF TRANSPORTATION

151 Carolyn Scarabin
EXECUTIVE SECRETARY,
STATE OF FLORIDA DEPARTMENT
OF TRANSPORTATION

ACCEPTED FOR FILES AND RECORDED IN THE PUBLIC RECORDS OF
MARTIN COUNTY, FLORIDA, THIS 28th DAY OF Nov. A.D.
1977 IN RIGHT OF WAY PLAT BOOK 7 PAGE 80

151 Louise V. Isaacs
CLERK OF CIRCUIT COURT
MARTIN COUNTY, FLORIDA

THIS IS TO CERTIFY THAT THE RIGHT OF WAY LIMITS AS SHOWN ON
THIS MAP HAVE BEEN MAINTAINED CONTINUOUSLY FOR FOUR (4) YEARS
IMMEDIATELY PAST WITHOUT INTERRUPTION OR DISTURBANCE BETWEEN
MILE POSTS 3.487 AND 3.960, (S.L.D.)

151 J.R. Thaxton
MAINTENANCE ENGINEER

THIS MAP FILED UNDER 89000
ENGINEERING FOLDER MISC. 6

STATE OF FLORIDA DEPARTMENT OF TRANSPORTATION	
MAINTENANCE MAP	
STATE ROAD No. 707 (AIA)	MARTIN COUNTY
DATE	APPROVED BY
BALOGH 6-7-77	<u>William E. J...</u> 8/27/77
BALOGH 6-7-77	DISTRICT ENGINEER
HALL 6-7-77	<u>E.L. MERKEL</u> 11-9-77
	DISTRICT ENGINEER
89030-	SHEET 1 OF 2

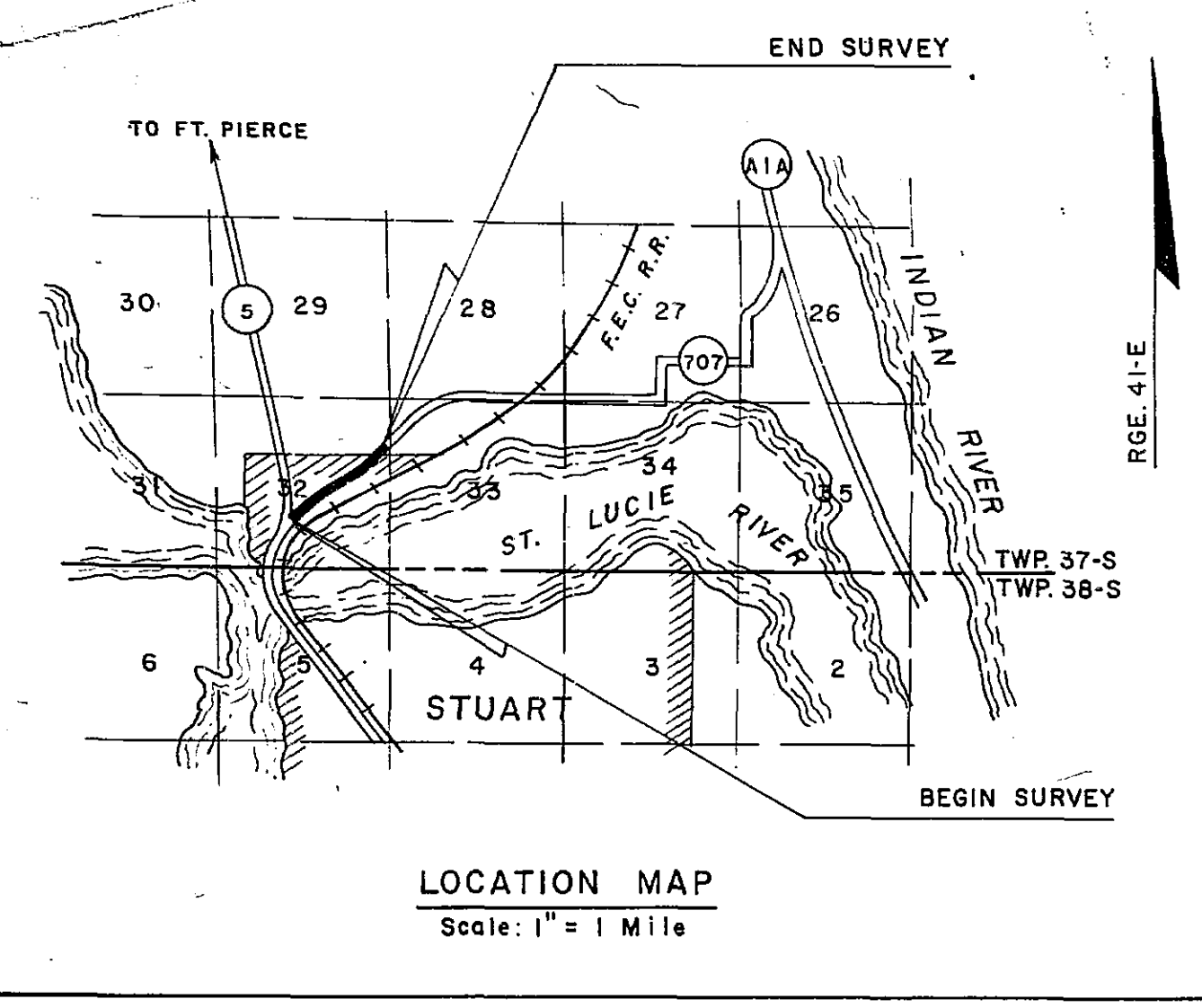

Sec. 32 Twp. 37-S Rge. 41-E
Scale: 1" = 100'

SURVEY CURVE DATA
P.I. STA. 45 + 25.42
 $\Delta = 02^{\circ}41'30''$ LT.
D = 00'39" 31"
T = 204.34'
L = 408.60'
R = 8697.71'

SURVEY CURVE DATA
P.I. STA. 57 + 44.41
 $\Delta = 05^{\circ}38'16''$ LT.
D = 01'18" 55"
T = 215.41'
L = 430.47'
R = 4374.79'

(89010-2205)
SURVEY S.R. 5 CURVE DATA (CHORD)
P.I. STA. 119 + 39.79
 $\Delta = 35^{\circ}56'15''$ LT.
D = 5'00" 00"
R = 1146.28'
T = 371.76'
L = 718.75'

P.I. S.R. 5
STA. 119 + 39.79 =
@ STA. 30 + 72.89

P.I. S.R. 5
STA. 119 + 39.79 =
@ STA. 30 + 72.89

BEGIN SURVEY
@ STA. 30 + 00.00

SURVEY CURVE DATA
P.I. STA. 36 + 40.88
 $\Delta = 24^{\circ}51'08''$ RT.
D = 01'58" 12"
T = 640.88'
L = 1261.60'
R = 2908.57'

MAINTENANCE R/W LINE STATION AND OFFSETS FROM @ SURVEY

STATION	LEFT	RIGHT
36+28	19'	
38+00	21'	
39+00	25'	
40+00	25'	
41+00	24'	
42+00	22'	22'
43+00	20'	21'
44+00	21'	23'
45+00	22'	23'
46+00	22'	22'
47+00	21'	20'
48+00	18'	20'
49+00	18'	23'
50+00	23'	24'
51+00	23'	24'
51+90	-	24'
52+00	22'	20'
52+25	-	30'
53+00	12.5'	12.5'
53+20	23'	25'
54+00	23'	21'
55+00	17'	18'
56+00	18'	18'
57+00	16'	21'
58+00	17'	20'
59+00	17'	19'
60+00	20'	22'
61+00	23'	25'
62+00	23'	25'

NOTE:
LOCATION OF R.R. AND R.R. TIES ARE FROM
FIELD SURVEY BOOK NO. 1015529, IN YEAR 1977.

END SURVEY
@ STA. 62 + 00.00

STATE OF FLORIDA
DEPARTMENT OF TRANSPORTATION
MAINTENANCE MAP

STATE ROAD No. 707 (A1A) MARTIN COUNTY

DRAWN	BALOGH	5-18-77	APPROVED BY	<i>William L. Justice</i>
TRACED	BALOGH	5-18-77	DISTRICT ENGINEER	
CHECKED	HALL	5-18-77	DATE	11-9-77
COMPARED			ENGINEER OF RIGHT OF WAY	
INDEXED			STATE HIGHWAY ENGINEER	

SECTION 89030- SHEET 2 OF 2