

FED. ROAD DIV. No.	STATE	PROJECT No.	FISCAL YEAR	SHEET No.
3	FLA.			

STATE JOB No. 89501-2601

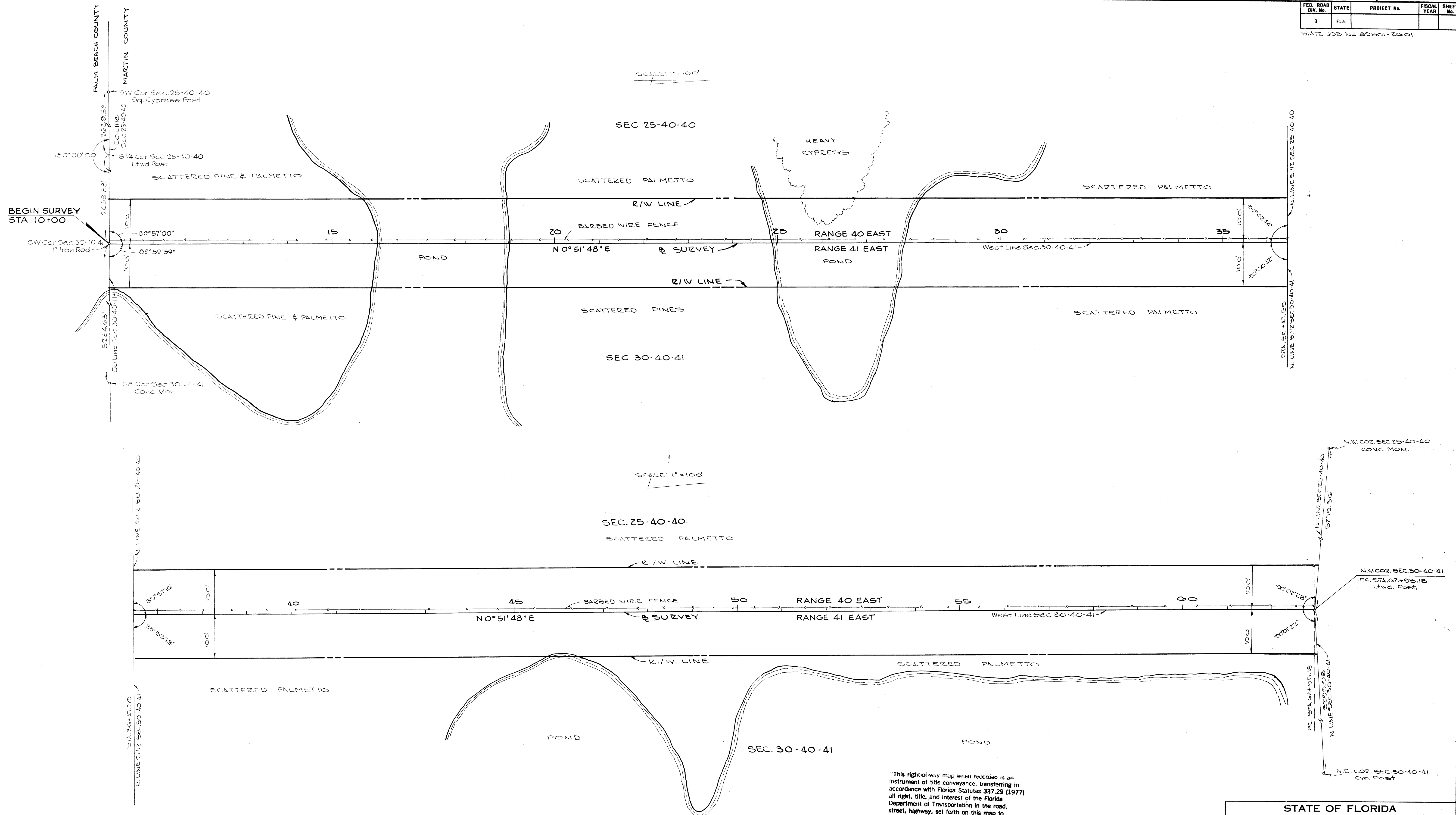

"This right-of-way map when recorded is an instrument of title conveyance, transferring in accordance with Florida Statutes 337.29 (1977) all right, title, and interest of the Florida Department of Transportation in the road, street, highway, set forth on this map to _____ County."

Recorded in Public Records of _____ County, Florida, this _____ day of _____ A.D. 19____ in Road Plat Book _____ Page _____

Clerk of Circuit Court

County, Florida.

STATE OF FLORIDA STATE ROAD DEPARTMENT				
RIGHT OF WAY MAP				
STATE ROAD NO. 3-711		MARTIN COUNTY		
DRAWN	BY	DATE	APPROVED BY	DATE
TRACED	C.L.M.	MAY 1965	<i>Clarence P. ...</i>	MAY 1965
CHECKED				
COMPARED				
INDEXED				
REVISION			BY	DATE
SECTION 89501-2601			SHEET 2 OF 8	