

This right of way map when recorded is an instrument of conveyance, transferring in accordance with Florida Statutes 337.29 and 335.0415 all right, title, and interest of Martin County in the road, street, highway, set forth on this map to the State of Florida Department of Transportation.

Recorded in Public Records of Martin County, Florida, this _____ day of _____, A.D.2010, in Road Plat Book _____, Page _____.

Clerk of the Circuit Court
Martin County, Florida

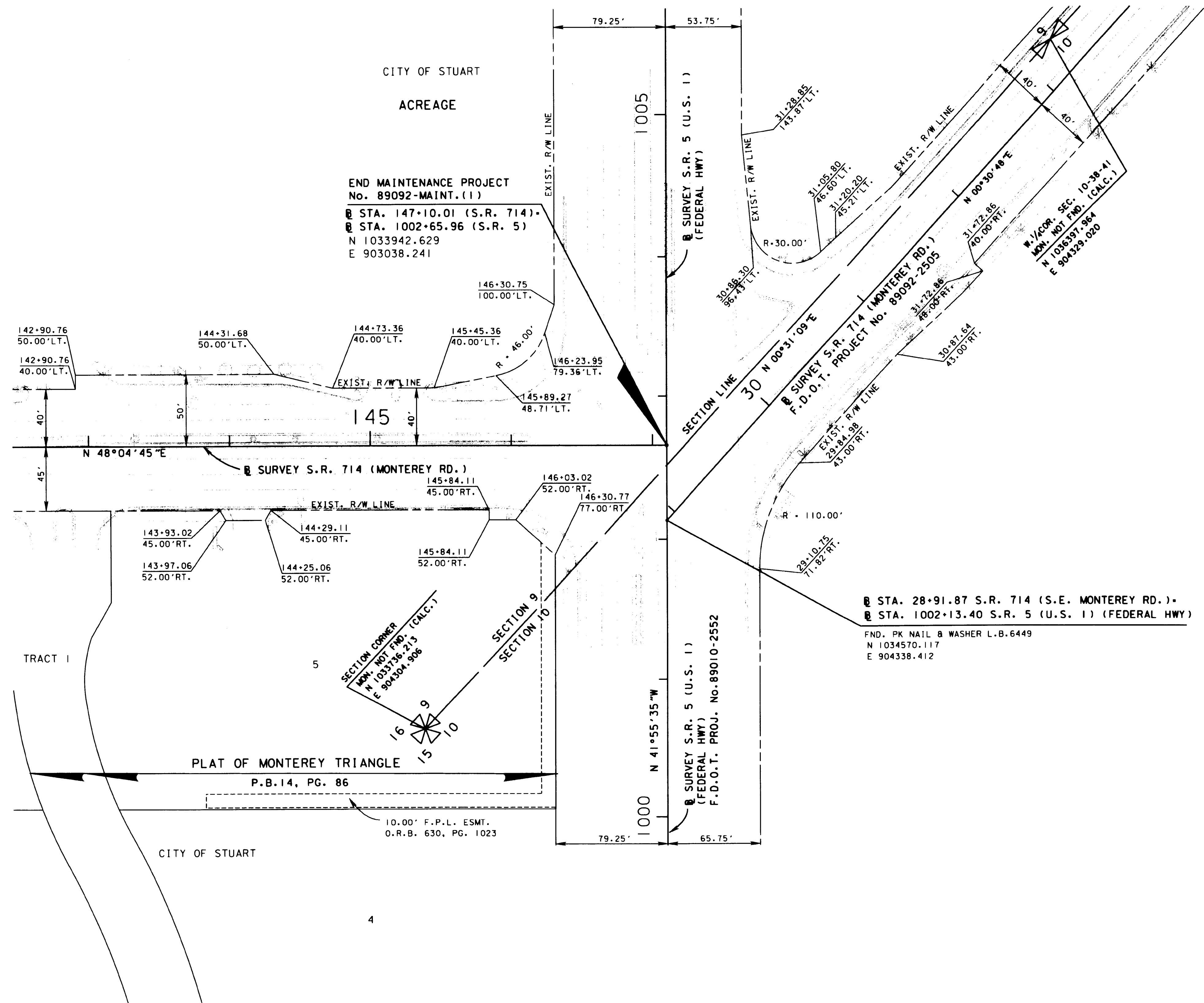
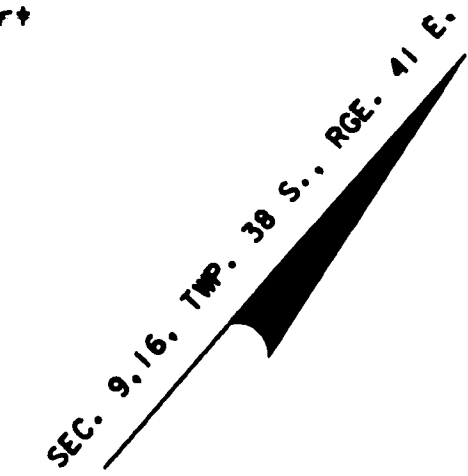

SEE SHEET ONE FOR LEGEND AND GENERAL NOTES

S.R. 714 (MONTEREY ROAD) FROM S.W. PALM CITY ROAD TO S.R. 5 (U.S. 1-FEDERAL HIGHWAY)

MAINTENANCE MAP

FLORIDA DEPARTMENT OF TRANSPORTATION
RIGHT OF WAY MAPPING

APPROVED BY	DATE	BY	DATE
	11-20-03	PRELIM	MORAVA 03-17-03
		FINAL	MORAVA 03-31-03
DISTRICT RIGHT OF WAY SURVEYOR		CHECKED	BROWN 06-25-03
REVISION	BY	DATE	REVISION

FED. PROJ. NO. N/A	SECTION 89092-MAINT.(1)	MAPS PREPARED BY	FIELD BOOK NO.'S
		F.D.O.T. DISTRICT 4	
STATE ROAD NO. 714	MARTIN COUNTY	W.P.I. NO. N/A	SCALE: 1" = 40'
		ITEM/SEGMENT NO. 2288621	SHEET 8 OF 8