

# SAND TRAIL P.U.D.

LYING IN SECTIONS 2 AND 3, TOWNSHIP 38 SOUTH, RANGE 40 EAST,  
MARTIN COUNTY, FLORIDA.

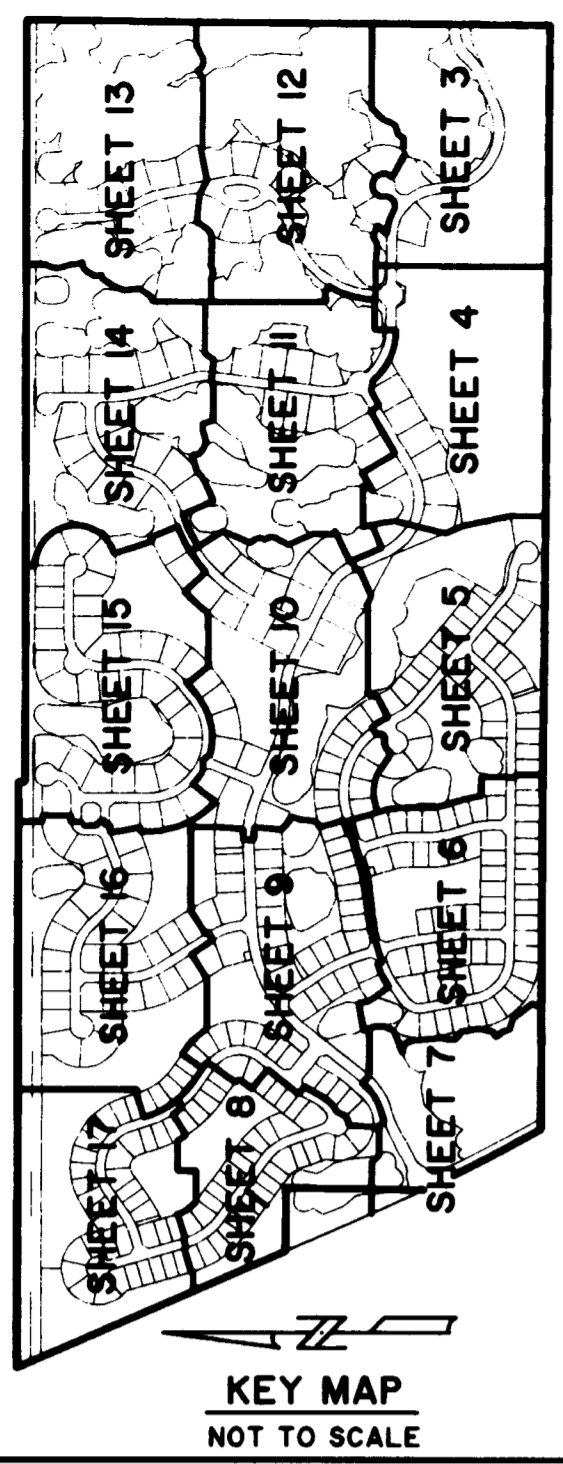

KEY MAP  
NOT TO SCALE

- LEGEND**
- PERMANENT CONTROL POINT
  - PERMANENT REFERENCE MONUMENT
  - CONCRETE MONUMENT
  - OFFICIAL RECORD BOOK
  - PLAT BOOK
  - PAGE(S)
  - CENTERLINE
  - UTILITY EASEMENT
  - DRAINAGE EASEMENT
  - RADIUS
  - ARC LENGTH
  - CURVE CENTRAL ANGLE
  - POINT OF BEGINNING
  - POINT OF COMMENCEMENT
  - SET 4"x4"x24" C.M. WITH ALUMINUM DISK, STAMPED P.R.M. L.B. 4396
  - FOUND 4"x 4" C.M. (AS SHOWN)
  - STAMPED P.C.P. LB 4396
  - SET 1/2"x18" IRON ROD WITH CAP, STAMPED LB 4396
  - LAKE MAINTENANCE EASEMENT
  - CHORD LENGTH
  - CHORD BEARING
  - NORTHING
  - EASTING
  - LIFT STATION EASEMENT
  - OVERALL
  - RADIAL LINE
  - PLANNED UNIT DEVELOPMENT

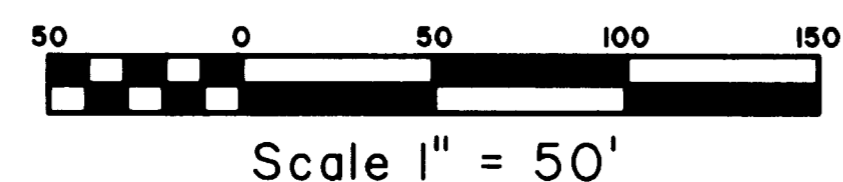

NOTE: SEE SHEET 2 OF 17 FOR SURVEYOR'S NOTES

SHEET 9 OF 17

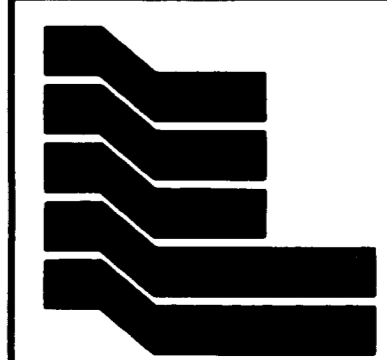

Landmark Surveying & Mapping Inc.  
1850 Forest Hill Boulevard  
Ph. (561) 433-5405 Suite 100 W.P. Florida  
LB # 4396

SAND TRAIL P.U.D.

Q:\LIBRARY\EPW\13\J085\2632\2632.dwg P1: Feb 16 08:37:07 2007 PLOTTED BY LESLIE C. BIRSPOTT