

CURVE TABLE	
C18	CA=40°48'07" R=85.00' L=46.29' LCB=578°50'25"W CHD=45.32'
C78	CA=43°52'15" R=85.00' L=49.77' LCB=N80°25'13"W CHD=48.56'
C257	CA=02°33'16" R=525.00' L=23.41' LCB=S59°45'44"E CHD=23.40'
C266	CA=01°07'56" R=2235.00' L=44.17' LCB=S81°19'29"E CHD=44.17'
C267	CA=27°53'27" R=85.00' L=31.84' LCB=S85°17'48"W CHD=31.33'
C268	CA=12°54'40" R=85.00' L=14.85' LCB=S64°53'42"W CHD=14.82'
C269	CA=07°26'31" R=525.00' L=88.19' LCB=N62°09'37"E CHD=88.14'
C270	CA=12°54'40" R=275.00' L=81.97' LCB=S64°53'42"W CHD=81.84'
C271	CA=03°40'39" R=525.00' L=20.86' LCB=N82°36'50"W CHD=20.86'
C272	CA=01°07'56" R=2235.00' L=40.02' LCB=S81°19'29"E CHD=40.02'
C263	CA=00°07'43" R=785.00' L=1.72' LCB=N77°42'31"E CHD=1.72'
C294	CA=09°59'37" R=275.00' L=47.97' LCB=S82°38'28"W CHD=47.90'
C295	CA=34°08'17" R=84.87' L=36.53' LCB=N75°27'21"W CHD=37.96'
C296	CA=09°47'45" R=85.79' L=11.26' LCB=S82°34'37"W CHD=11.23'

TANGENT TABLE	
T-1195	N52°24'30"W 35.54'
T-1196	N56°31'24"W 31.14'
T-1197	N18°49'46"W 61.45'
T-1198	N20°32'38"E 29.78'
T-1199	N65°53'20"E 59.68'
T-1200	S60°21'17"E 34.13'
T-1201	S21°05'16"E 62.76'
T-1202	S10°14'42"E 52.10'
T-1203	S61°47'17"W 35.23'
T-1204	S74°32'43"W 22.22'

LEGEND	
(R)	DENOTES A RADIAL LINE
C/L	DENOTES A CENTERLINE
DE	DENOTES A PRIVATE DRAINAGE EASEMENT
UE	DENOTES UTILITY EASEMENT
LSE	DENOTES LIFT STATION EASEMENT
MCAE	DENOTES MARTIN COUNTY ACCESS EASEMENT
FM	DENOTES FORCEMAIN EASEMENT
LME	DENOTES LAKE MAINTENANCE EASEMENT
R	DENOTES RADIUS DISTANCE
L	DENOTES ARC LENGTH DISTANCE
CA	DENOTES CENTRAL ANGLE
LCB	DENOTES LONG CHORD BEARING
CHD	DENOTES CHORD DISTANCE
ORB	DENOTES OFFICIAL RECORDS BOOK
	DENOTES TRACT LINE OF THE PLAT OF PALM CITY FARMS PLAT BOOK 6, PAGE 42.
□	DENOTES A SET PERMANENT REFERENCE MONUMENT 4"x4" CONCRETE MONUMENT WITH DISK (LB 7344)
●	DENOTES A 5/8" IRON ROD AND CAP (LB 7344)
⊙	DENOTES A SET PERMANENT CONTROL POINT CARRIAGE BOLT AND WASHER (LB 7344)
⊕	DENOTES A FOUND PERMANENT CONTROL POINT CARRIAGE BOLT AND WASHER

SURVEYOR'S NOTES

1. THE BASE BEARING, AS SHOWN HEREON, IS N89°58'48"W ALONG THE SOUTHLINE OF THE SOUTHWEST ONE-QUARTER OF SECTION 15, TOWNSHIP 38 SOUTH, RANGE 40 EAST.
2. IN THOSE INSTANCES WHERE UTILITY OR DRAINAGE STRUCTURES ARE CONSTRUCTED IN CONFLICT WITH THE PLATTED PERMANENT CONTROL POINT POSITION STRADDLERS MONUMENTED AS PERMANENT CONTROL POINTS WILL BE SET TO REFERENCE THE PLATTED POSITION.
3. LINES THAT INTERSECT CURVES ARE RADIAL UNLESS OTHERWISE NOTED.
4. THIS INSTRUMENT WAS PREPARED BY WM. R. VAN CAMPEN, PROFESSIONAL SURVEYOR AND MAPPER NO. 2424, IN AND FOR THE OFFICES OF ASSOCIATED LAND SURVEYORS, INC., 4152 WEST BLUE HERON BOULEVARD, SUITE 121, RIVIERA BEACH, FLORIDA, 33404

ASSOCIATED LAND SURVEYORS, INC.
 4152 W. BLUE HERON BOULEVARD—SUITE 121
 RIVIERA BEACH, FLORIDA 33404 LB 7344
 PHONE: (561) 848-2102 FAX: (561) 844-9659 EMAIL: ALLSURVEY@AOL.COM

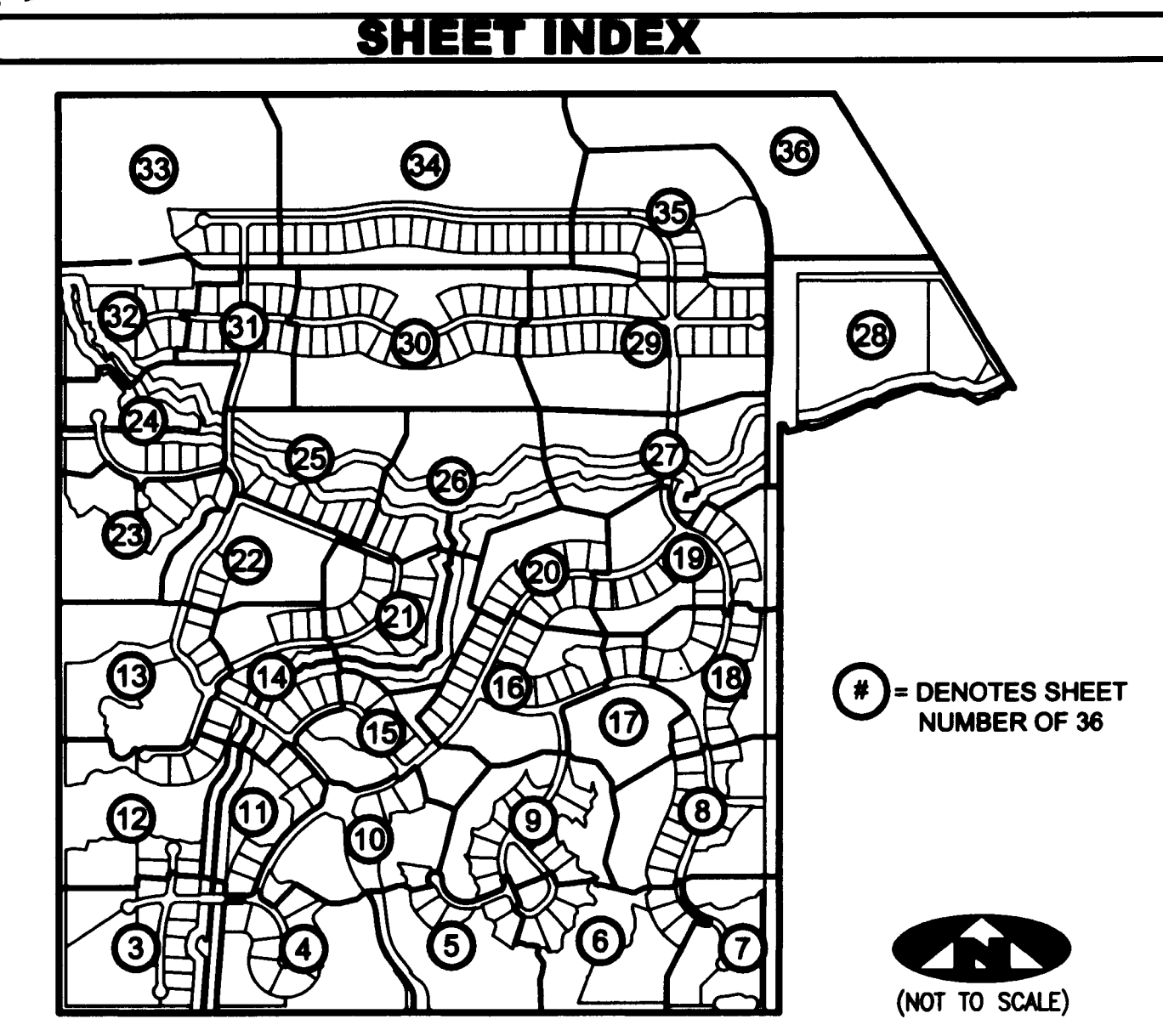

FILE: P260PLAT	
FB:	WO.NO.: P260
SCALE: 1"=80'	DATE: 1/6/2005
DWN: KVC	SHEET 30 OF 36