

TANGENT TABLE

Table of tangent data with columns for curve number, bearing, length, and chord distance. Includes entries from T-44 to T-1549.

CURVE TABLE

Table of curve data with columns for curve number, CA, R, L, LCB, and CHD. Includes entries from C124 to C220.

SHEET INDEX

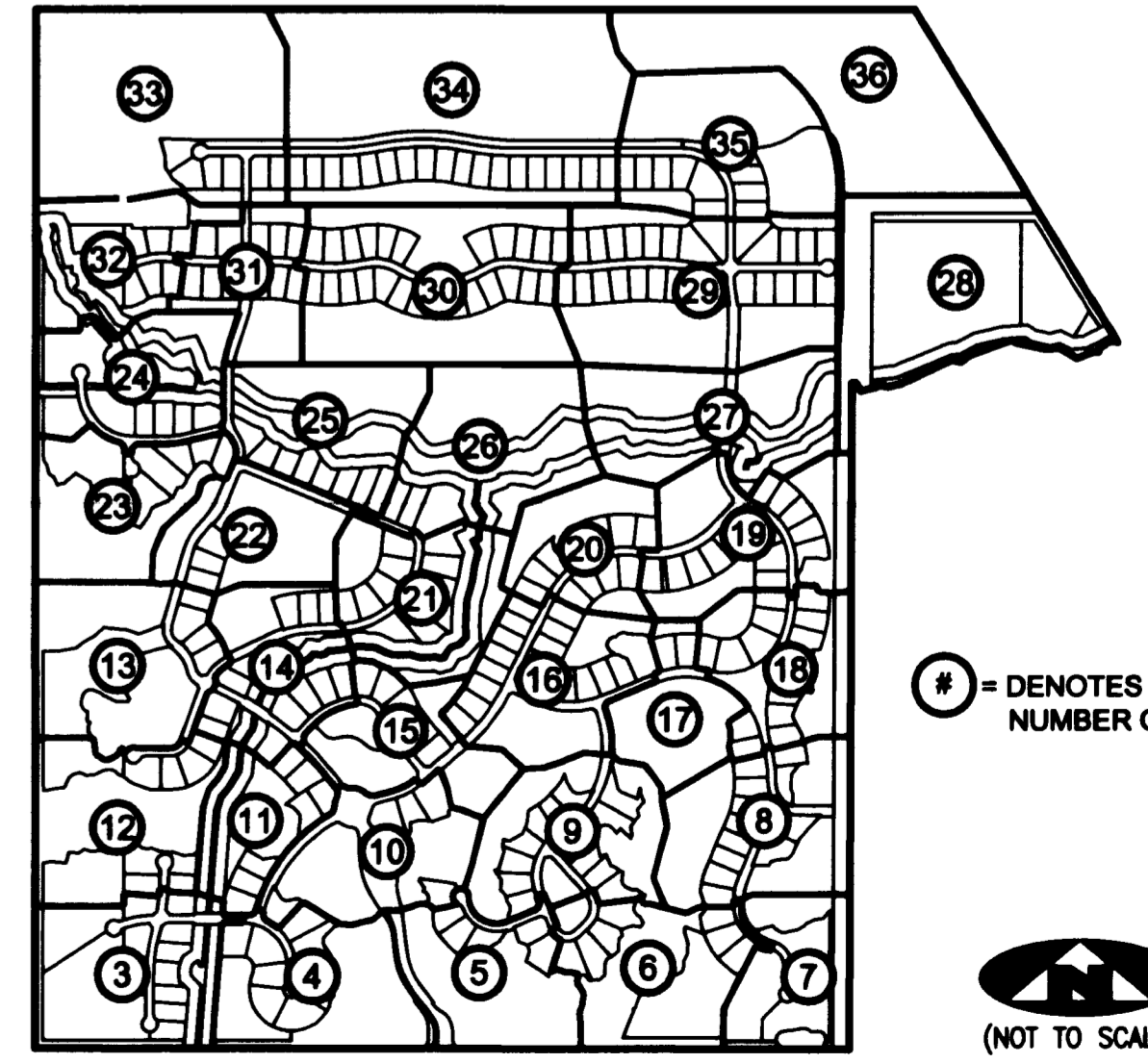

= DENOTES SHEET NUMBER OF 36



LEGEND

- Legend items: (R) DENOTES A RADIAL LINE, C/L DENOTES A CENTERLINE, DE DENOTES A PRIVATE DRAINAGE EASEMENT, UE DENOTES UTILITY EASEMENT, LSE DENOTES LIFT STATION EASEMENT, MCAE DENOTES MARTIN COUNTY ACCESS EASEMENT, FM DENOTES FORCEMAIN EASEMENT, LME DENOTES LAKE MAINTENANCE EASEMENT, R DENOTES RADIUS DISTANCE, CA DENOTES ARC LENGTH DISTANCE, LA DENOTES CENTRAL ANGLE, LCB DENOTES LONG CHORD BEARING, CHD DENOTES CHORD DISTANCE, ORB DENOTES OFFICIAL RECORDS BOOK, TRACT LINE DENOTES TRACT LINE OF THE PLAT OF PALM CITY FARMS PLAT BOOK 6, PAGE 42, DENOTES A SET PERMANENT REFERENCE MONUMENT, DENOTES A 5/8" IRON ROD AND CAP, DENOTES A SET PERMANENT CONTROL POINT, DENOTES CARRIAGE BOLT AND WASHER, DENOTES A FOUND PERMANENT CONTROL POINT, DENOTES CARRIAGE BOLT AND WASHER.

SURVEYOR'S NOTES

- Notes: 1. THE BASE BEARING, AS SHOWN HEREON, IS N89°58'48"W ALONG THE SOUTHLINE OF THE SOUTHWEST ONE-QUARTER OF SECTION 15, TOWNSHIP 38 SOUTH, RANGE 40 EAST. 2. IN THOSE INSTANCES WHERE UTILITY OR DRAINAGE STRUCTURES ARE CONSTRUCTED IN CONFLICT WITH THE PLATTED PERMANENT CONTROL POINT POSITION STRADDLERS MONUMENTED AS PERMANENT CONTROL POINTS WILL BE SET TO REFERENCE THE PLATTED POSITION. 3. LINES THAT INTERSECT CURVES ARE RADIAL UNLESS OTHERWISE NOTED. 4. THIS INSTRUMENT WAS PREPARED BY WM. R. VAN CAMPEN, PROFESSIONAL SURVEYOR AND MAPPER NO. 2424, IN AND FOR THE OFFICES OF ASSOCIATED LAND SURVEYORS, INC., 4152 WEST BLUE HERON BOULEVARD, SUITE 121, RIVIERA BEACH, FLORIDA, 33404



ASSOCIATED LAND SURVEYORS, INC. 4152 W. BLUE HERON BOULEVARD-SUITE 121 RIVIERA BEACH FLORIDA 33404 LB 7344 PHONE: (561) 848-2102 FAX: (561) 844-9659 EMAIL: ALLSURVEY@AOL.COM

Table with columns: FILE: P260PLAT, FB: WO.NO.: P260, SCALE: 1"=80' DATE: 1/6/2005, DWN: KVC SHEET 6 OF 36