

TANGENT TABLE

T-43	S00°01'12"W	50.43'
T-52	S40°09'28"E	38.22'
T-53	N49°55'07"E	31.59'
T-54	N38°30'22"W	41.03'
T-55	S52°38'17"W	30.34'
T-701	S85°37'34"E	16.17'
T-702	S19°48'47"E	36.63'
T-703	N56°41'50"E	38.53'
T-704	N21°41'43"E	25.01'
T-705	N11°5'00"E	23.84'
T-706	N05°35'35"W	22.64'
T-707	N49°11'30"W	10.64'
T-708	N44°45'50"W	37.16'
T-709	N43°36'44"W	42.26'
T-710	N04°27'47"E	45.70'
T-711	N56°41'50"E	64.74'
T-712	N21°41'43"E	55.51'
T-713	N11°5'00"E	41.80'
T-714	N05°35'35"W	63.74'
T-715	N49°11'30"W	37.74'
T-716	N44°45'50"W	33.50'
T-717	N43°36'44"W	8.13'
T-718	N04°27'47"E	53.45'
T-719	N04°27'47"E	59.26'

CURVE TABLE

C44	CA=46°24'32"	R=23.00'	L=18.63'	LCB=S86°55'54"E	CHD=18.12'
C45	CA=51°41'02"	R=23.00'	L=20.75'	LCB=S44°26'40"W	CHD=20.05'
C47	CA=48°11'23"	R=25.00'	L=21.03'	LCB=N24°00'45"E	CHD=20.41'
C48	CA=48°11'23"	R=25.00'	L=21.03'	LCB=S24°10'37"E	CHD=20.41'
C49	CA=01°32'02"	R=1025.00'	L=27.44'	LCB=N16°03'11"E	CHD=27.44'
C60	CA=16°03'16"	R=575.00'	L=161.12'	LCB=S78°18'49"W	CHD=160.59'
C339	CA=138°47'24"	R=50.00'	L=121.12'	LCB=S46°52'40"W	CHD=93.60'
C340	CA=138°52'50"	R=50.00'	L=121.20'	LCB=N88°02'34"E	CHD=93.63'
C341	CA=138°05'15"	R=50.00'	L=120.50'	LCB=S20°56'11"E	CHD=93.39'
C342	CA=118°52'41"	R=50.00'	L=103.74'	LCB=N30°34'52"E	CHD=86.11'
C343	CA=19°24'50"	R=50.00'	L=16.94'	LCB=N38°33'54"W	CHD=16.86'
C396	CA=02°08'59"	R=625.00'	L=23.45'	LCB=S70°56'20"W	CHD=23.45'
C398	CA=03°42'34"	R=1000.00'	L=64.74'	LCB=N14°57'55"E	CHD=64.73'

SHEET INDEX

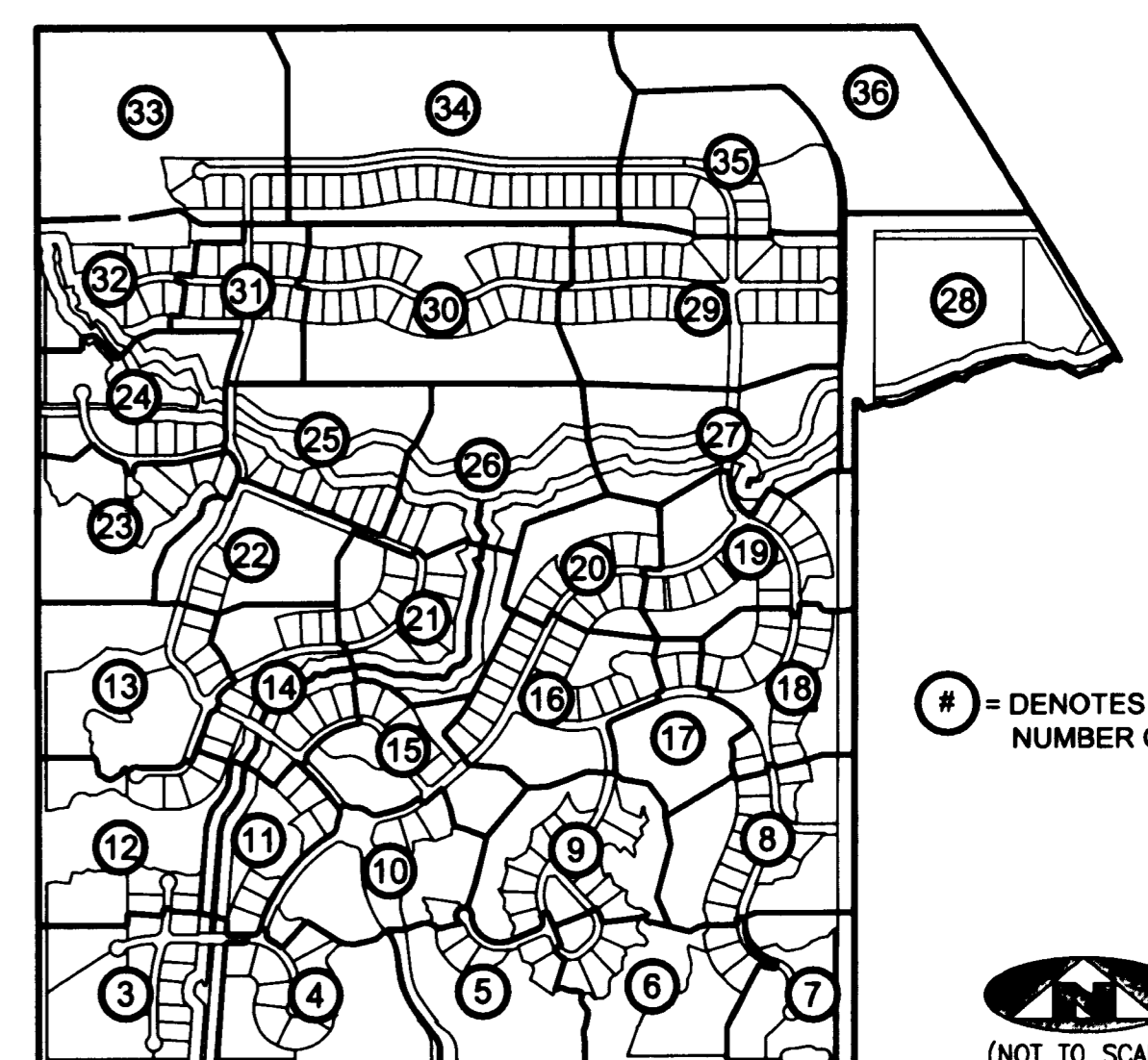

= DENOTES SHEET NUMBER OF 36



(NOT TO SCALE)

LEGEND

(R)	DENOTES A RADIAL LINE	R	DENOTES RADIUS DISTANCE
C/L	DENOTES A CENTERLINE	L	DENOTES ARC LENGTH DISTANCE
DE	DENOTES A PRIVATE DRAINAGE EASEMENT	CA	DENOTES CENTRAL ANGLE
UE	DENOTES UTILITY EASEMENT	LCB	DENOTES LONG CHORD BEARING
LSE	DENOTES LIFT STATION EASEMENT	CHD	DENOTES CHORD DISTANCE
MCAE	DENOTES MARTIN COUNTY ACCESS EASEMENT	ORB	DENOTES OFFICIAL RECORDS BOOK
FM	DENOTES FOREMAN EASEMENT	TR	DENOTES TRACT LINE OF THE PLAT OF PALM CITY FARMS PLAT BOOK 6, PAGE 42.
LME	DENOTES LAKE MAINTENANCE EASEMENT		

□	DENOTES A SET PERMANENT REFERENCE MONUMENT 4"x4" CONCRETE MONUMENT WITH DISK (LB 7344)
●	DENOTES A 5/8" IRON ROD AND CAP
⊙	DENOTES A SET PERMANENT CONTROL POINT CARRIAGE BOLT AND WASHER (LB 7344)
⊙	DENOTES A FOUND PERMANENT CONTROL POINT CARRIAGE BOLT AND WASHER

SURVEYOR'S NOTES

1. THE BASE BEARING, AS SHOWN HEREON, IS N89°58'48"W ALONG THE SOUTHLINE OF THE SOUTHWEST ONE-QUARTER OF SECTION 15, TOWNSHIP 38 SOUTH, RANGE 40 EAST.
2. IN THOSE INSTANCES WHERE UTILITY OR DRAINAGE STRUCTURES ARE CONSTRUCTED IN CONFLICT WITH THE PLATTED PERMANENT CONTROL POINT POSITION STRADDLERS MONUMENTED AS PERMANENT CONTROL POINTS WILL BE SET TO REFERENCE THE PLATTED POSITION.
3. LINES THAT INTERSECT CURVES ARE RADIAL UNLESS OTHERWISE NOTED.
4. THIS INSTRUMENT WAS PREPARED BY WM. R. VAN CAMPEN, PROFESSIONAL SURVEYOR AND MAPPER NO. 2424, IN AND FOR THE OFFICES OF ASSOCIATED LAND SURVEYORS, INC., 4152 WEST BLUE HERON BOULEVARD, SUITE 121, RIVIERA BEACH, FLORIDA, 33404



ASSOCIATED LAND SURVEYORS, INC.
 4152 W. BLUE HERON BOULEVARD—SUITE 121
 RIVIERA BEACH FLORIDA 33404 LB 7344
 PHONE: (561) 848-2102 FAX: (561) 844-9659 EMAIL: ALSURVEY@AOL.COM

FILE: P260PLAT	
FB: WO.NO.: P260	
SCALE: 1"=60'	DATE: 1/6/2005
DWN: KVC	SHEET 3 OF 36