

JUNE 2006

WHITEMARSH RESERVE PUD PHASE 2

SHEET 1 OF 3
Plat Book 16 Page 38

BEING A REPLAT OF ALL OF TRACTS "B", "C", "D", "E" AND "F", WHITEMARSH RESERVE PUD PHASE 1, RECORDED IN PLAT BOOK 16, PAGE 5, PUBLIC RECORDS, MARTIN COUNTY, FLORIDA

PARCEL CONTROL NO. 41-38-41-007-000-0000.0

I, MARSHA EWING, CLERK OF THE CIRCUIT COURT OF MARTIN COUNTY, FLORIDA, HEREBY CERTIFY THAT THIS PLAT WAS FILED FOR RECORD IN PLAT BOOK 16, PAGE 38, MARTIN COUNTY, FLORIDA, PUBLIC RECORDS, THIS 31 DAY OF October, 2006

MARSHA EWING
CIRCUIT COURT
MARTIN COUNTY, FLORIDA
BY: Charlotte Buskey
DEPUTY CLERK
(CIRCUIT COURT SEAL)

FILE NO. 1964150



10 OCT -3 PM 2:47
CLERK OF CIRCUIT COURT
BY: Charlotte Buskey
DEPUTY CLERK
D.C.

LEGAL DESCRIPTION:

PARCELS OF LAND BEING A REPLAT OF ALL OF TRACTS "B", "C", "D", "E" AND "F", WHITEMARSH RESERVE PUD PHASE 1, RECORDED IN PLAT BOOK 16, PAGE 5, PUBLIC RECORDS, MARTIN COUNTY, FLORIDA. CONTAINING: 6.51 ACRES, MORE OR LESS.

CERTIFICATE OF OWNERSHIP:

LENNAR HOMES, INC., A FLORIDA CORPORATION, BY AND THROUGH ITS UNDERSIGNED VICE PRESIDENT, HEREBY CERTIFIES THAT IT IS THE OWNER OF THE PROPERTY DESCRIBED ON THE PLAT OF WHITEMARSH RESERVE PUD PHASE 2.

IN WITNESS WHEREOF, LENNAR HOMES, INC., A FLORIDA CORPORATION, BY AND THROUGH ITS UNDERSIGNED OFFICER, DOES HEREBY CERTIFY THAT IT IS THE OWNER OF THE PROPERTY DESCRIBED HEREON.

DATED THIS 10th DAY OF July, 2006

WITNESS (1): Mallika Thomas

PRINT NAME: MALLIKA THOMAS

WITNESS (2): Caroline Villanueva

PRINT NAME: CAROLINE VILLANUEVA

LENNAR HOMES, INC.
A FLORIDA CORPORATION

BY: David Baselice
DAVID BASELICE, VICE PRESIDENT

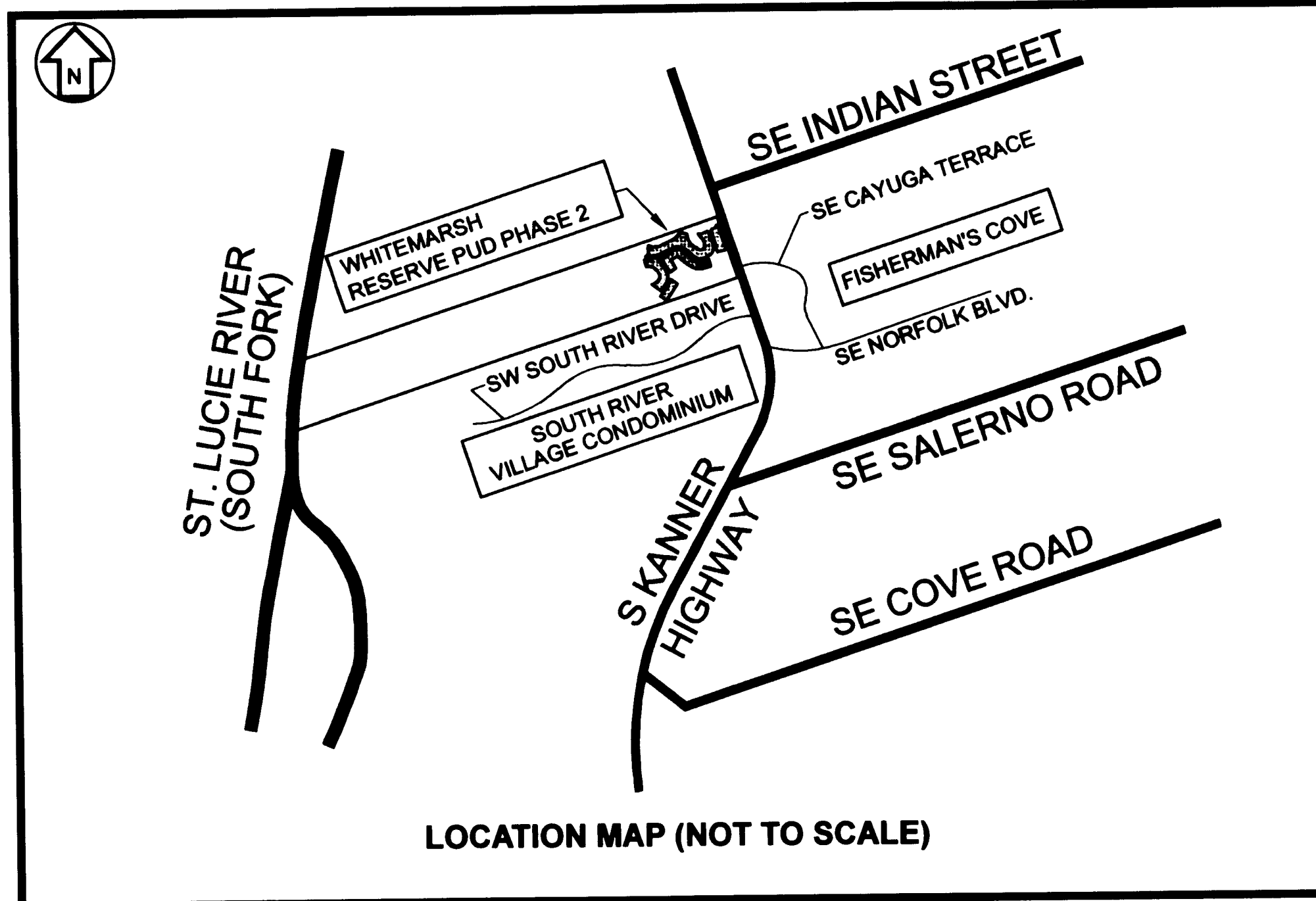

LOCATION MAP (NOT TO SCALE)

SURVEYOR'S NOTES:

1. THERE SHALL BE NO BUILDINGS OR ANY OTHER KIND OF CONSTRUCTION OR TREES OR SHRUBS PLACED ON DRAINAGE EASEMENTS.
2. THERE SHALL BE NO BUILDINGS OR OTHER PERMANENT STRUCTURES PLACED ON UTILITY EASEMENTS.
3. WHERE DRAINAGE AND UTILITY EASEMENTS CROSS, DRAINAGE EASEMENTS SHALL TAKE PRECEDENCE.

ACKNOWLEDGEMENT:

STATE OF FLORIDA)
) SS
COUNTY OF PALM BEACH)

BEFORE ME PERSONALLY APPEARED DAVID BASELICE WHO IS PERSONALLY KNOWN TO ME, AND WHO EXECUTED THE FOREGOING INSTRUMENT AS VICE PRESIDENT OF LENNAR HOMES, INC., A FLORIDA CORPORATION, AND HE ACKNOWLEDGED TO AND BEFORE ME THAT HE EXECUTED SUCH CERTIFICATE OF OWNERSHIP AS VICE PRESIDENT OF SAID CORPORATION AND THAT IT IS THE FREE ACT AND DEED OF SAID LENNAR HOMES, INC., A FLORIDA CORPORATION.

WITNESS MY HAND THIS 10th DAY OF July, 2006.

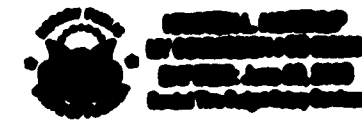

June 20th, 2008 BY: Kristen L. Northup
MY COMMISSION EXPIRES NOTARY PUBLIC

SEAL: Commission # DD 392023

PRINTED NAME: KRISTEN L. NORTHUP

TITLE CERTIFICATION:

I, GERALD L. KNIGHT, A MEMBER OF THE FLORIDA BAR, HEREBY CERTIFY THAT AS OF June 30, 2006.

1. RECORD TITLE TO THE LAND DESCRIBED AND SHOWN ON THIS PLAT IS IN THE NAME OF LENNAR HOMES, INC., A FLORIDA CORPORATION.
2. THERE ARE NO MORTGAGES ENCUMBERING THE LAND DESCRIBED HEREON.
3. ALL TAXES THAT ARE DUE AND PAYABLE PURSUANT TO SECTION 197.192, FLORIDA STATUTES, HAVE BEEN PAID.

DATED THIS 7th DAY OF July, 2006

BY: Gerald L. Knight
GERALD L. KNIGHT
FLORIDA BAR NO. 0174340
888 S.E. 3RD AVE., SUITE 301
FT. LAUDERDALE, FLORIDA 33316

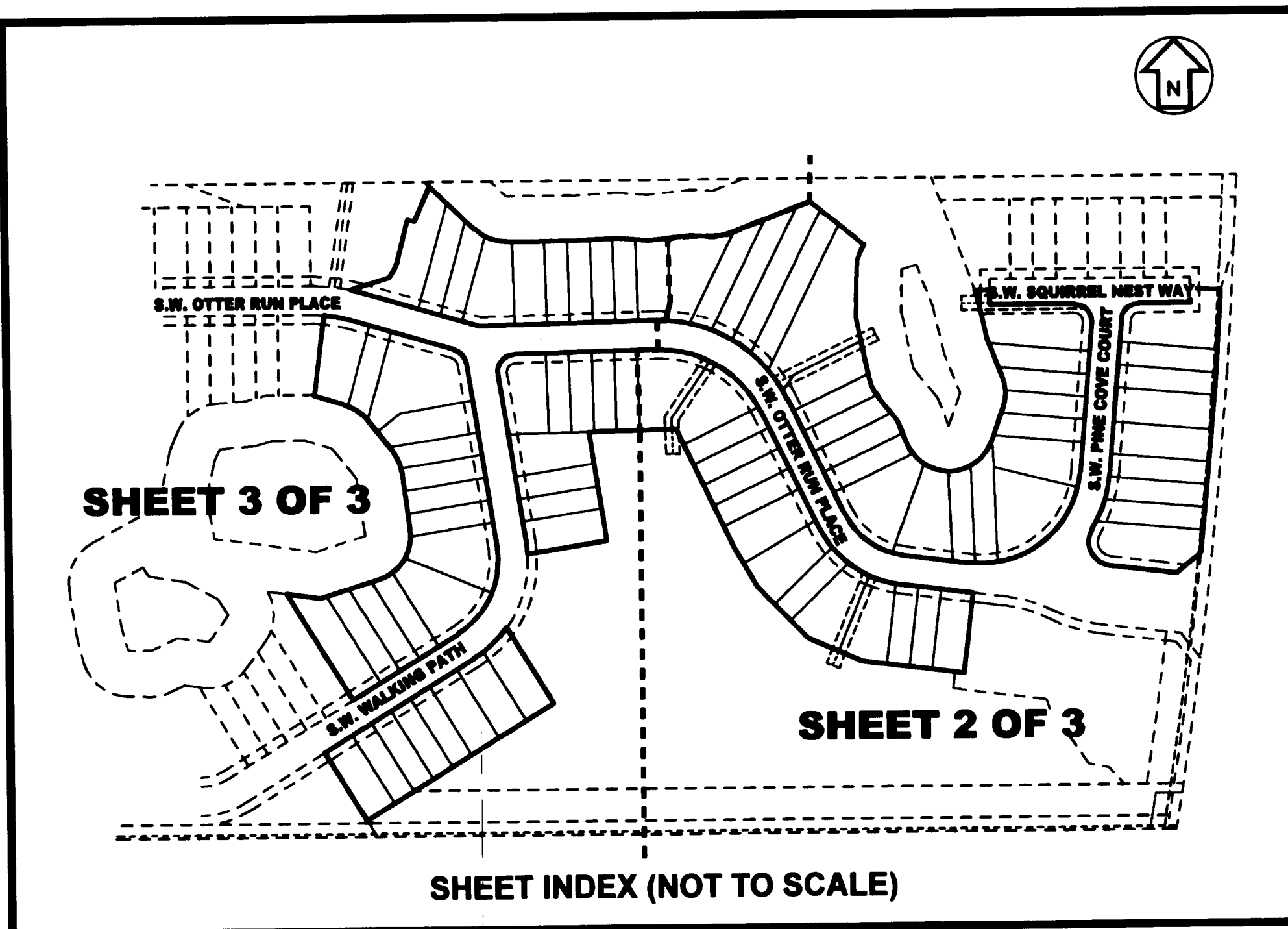

SHEET INDEX (NOT TO SCALE)

COUNTY APPROVAL:

THIS PLAT IS HEREBY APPROVED BY THE UNDERSIGNED ON THE DATES INDICATED:

DATE: 05/29/06

[Signature]
COUNTY SURVEYOR AND MAPPER

DATE: 09/29/06

[Signature]
COUNTY ENGINEER

DATE: 10/2/06

[Signature]
COUNTY ATTORNEY

DATE: 10/3/06

[Signature]
CHAIRMAN, BOARD OF COUNTY COMMISSIONERS

CC: 6/6/06

ATTEST: Marsha Ewing
CLERK OF COURT
by Charlotte Buskey, d.c.

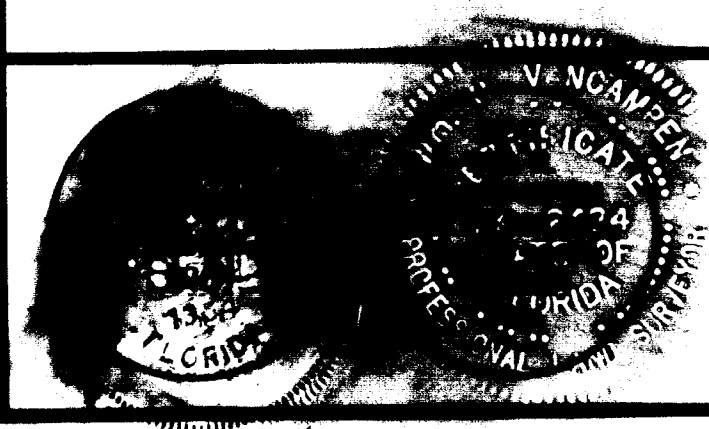

CERTIFICATE OF SURVEYOR AND MAPPER

I, WILLIAM R. VAN CAMPEN, HEREBY CERTIFY THAT THIS PLAT OF WHITEMARSH RESERVE PUD PHASE 2 IS A TRUE AND CORRECT REPRESENTATION OF THE LANDS SURVEYED, THAT SUCH SURVEY AND PLAT WAS MADE UNDER MY RESPONSIBLE DIRECTION AND SUPERVISION; THAT SUCH SURVEY AND PLAT ARE ACCURATE TO THE BEST OF MY KNOWLEDGE AND BELIEF; THAT PERMANENT REFERENCE MONUMENTS HAVE BEEN PLACED AS REQUIRED BY LAW; THAT PERMANENT CONTROL POINTS AND MONUMENTS ACCORDING TO SECTION 177.091 (9) FLORIDA STATUTES WILL BE SET FOR THE REQUIRED IMPROVEMENTS WITHIN THE PLATTED LANDS; AND, FURTHER, THAT THE SURVEY DATA COMPLIES WITH ALL THE REQUIREMENTS OF CHAPTER 177, FLORIDA STATUTES, AND APPLICABLE ORDINANCES OF MARTIN COUNTY, FLORIDA.

BY: William R. Van Campen DATED THIS 7th DAY OF July, 2006
WILLIAM R. VAN CAMPEN, PROFESSIONAL SURVEYOR & MAPPER
REGISTRATION NO. 2424, ASSOCIATED LAND SURVEYORS, INC., LB 7344

NOTICE:

THIS PLAT AS RECORDED IN ITS GRAPHIC FORM, IS THE OFFICIAL DEPICTION OF THE SUBDIVIDED LANDS DESCRIBED HEREIN AND WILL IN NO CIRCUMSTANCES BE SUPPLANTED IN AUTHORITY BY ANY OTHER GRAPHIC OR DIGITAL FORM OF THE PLAT. THERE MAY BE ADDITIONAL RESTRICTIONS THAT ARE NOT RECORDED ON THIS PLAT THAT MAY BE FOUND IN THE PUBLIC RECORDS OF THIS COUNTY.

THIS INSTRUMENT WAS PREPARED BY WILLIAM R. VAN CAMPEN, PROFESSIONAL SURVEYOR & MAPPER NO. 2424 IN AND FOR THE OFFICES OF ASSOCIATED LAND SURVEYORS, INC., 4152 WEST BLUE HERON BOULEVARD, SUITE 121, RIVIERA BEACH, FLORIDA, LB 7344.

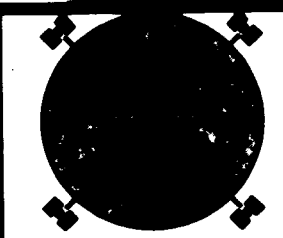

ASSOCIATED LAND SURVEYORS, INC.
4152 W. BLUE HERON BLVD.- SUITE 121
RIVIERA BEACH, FLORIDA 33404
PHONE: (888) 248-2102 FAX: (888) 244-8888 LB 7344

RECORD PLAT
WHITEMARSH RESERVE PUD PHASE 2 SHEET 1 OF 3