

# A PLAT OF TRES BELLE P.U.D. PLAT NO. 1

BEING A REPLAT OF A PORTION OF WRIGHTS MINOR PLAT, AS RECORDED IN PLAT BOOK 6, PAGE 19, MARTIN COUNTY, FLORIDA PUBLIC RECORDS

AND ALSO BEING A PORTION OF LAND LYING IN SECTION 4, TOWNSHIP 39 SOUTH, RANGE 41 EAST AND SECTION 33, TOWNSHIP 38 SOUTH, RANGE 41 EAST, MARTIN COUNTY, FLORIDA

## ACKNOWLEDGMENT

STATE OF FLORIDA  
COUNTY OF Collier Beach

I HEREBY CERTIFY THAT ON THIS DAY, BEFORE ME, AN OFFICER DULY AUTHORIZED IN THE STATE AFORESAID AND IN THE COUNTY AFORESAID TO TAKE ACKNOWLEDGMENTS, PERSONALLY APPEARED IVAN CHOSNEK, PRESIDENT OF IMC COMMUNITIES, LLC, A FLORIDA LIMITED LIABILITY COMPANY, AS AUTHORIZED REPRESENTATIVE FOR TREASURE COVE DEVELOPMENT CORP., A FLORIDA CORPORATION, TO ME KNOWN TO BE THE PERSON DESCRIBED HEREIN AND WHO EXECUTED THE FOREGOING INSTRUMENT AND ACKNOWLEDGED BEFORE ME THAT HE EXECUTED SAME.

WITNESS MY HAND AND OFFICIAL SEAL IN THE COUNTY AND STATE LAST AFORESAID THIS 11<sup>th</sup> DAY OF February 2005.

(NOTARIAL STAMP)



*Myrna Jean White*  
NOTARY PUBLIC  
MY COMMISSION EXPIRES: May 15, 2008  
#DD281407

## ACCEPTANCE OF DEDICATIONS

TRES BELLE HOMEOWNERS ASSOCIATION, INC., A FLORIDA NON-PROFIT CORPORATION (HEREINAFTER ASSOCIATION), DOES HEREBY ACCEPT OWNERSHIP AND DEDICATION OF ALL STREETS AND RIGHTS-OF-WAY, UTILITY EASEMENTS, DRAINAGE EASEMENTS, UPLAND AND WETLAND PRESERVE TRACTS, WATER MANAGEMENT TRACTS, PEDESTRIAN ACCESS TRACT AND COMMON AREAS AS SHOWN ON THE PLAT OF TRES BELLE P.U.D. PLAT NO. 1, AND HEREBY ACCEPTS ITS MAINTENANCE OBLIGATIONS FOR SAME AS STATED HEREON.

WITNESS: *Jeannie M. White*  
PRINT NAME: JEANNIE M. WHITE  
TRES BELLE HOMEOWNERS ASSOCIATION, INC.

WITNESS: *Louis S. Taylor*  
PRINT NAME: Louis S. Taylor  
BY: *Ivan Chosnek*  
PRINT NAME: IVAN CHOSNEK, PRESIDENT

## ACKNOWLEDGMENT

STATE OF FLORIDA  
COUNTY OF Collier Beach

BEFORE ME, THE UNDERSIGNED NOTARY PUBLIC, ON THIS 11<sup>th</sup> DAY OF February, 2005, PERSONALLY APPEARED IVAN CHOSNEK, TO ME WELL KNOWN TO BE THE PRESIDENT OF TRES BELLE HOMEOWNERS ASSOCIATION, INC., A FLORIDA NON-PROFIT CORPORATION, AND THAT HE ACKNOWLEDGED THAT HE EXECUTED SUCH ACCEPTANCE OF DEDICATIONS HEREON AS SUCH OFFICER OF THE CORPORATION AND THAT THE SEAL AFFIXED IS THE CORPORATE SEAL OF SAID CORPORATION AND IT WAS AFFIXED BY DUE AND REGULAR CORPORATE AUTHORITY, AND THAT IT IS THE FREE ACT AND DEED OF SAID CORPORATION. HE IS  PERSONALLY KNOWN TO ME OR  HAS PRODUCED \_\_\_\_\_ AS IDENTIFICATION.



*Myrna Jean White*  
NOTARY PUBLIC  
STATE OF FLORIDA  
COMMISSION NO. #DD 281407  
MY COMMISSION EXPIRES: May 15, 2008

## TITLE CERTIFICATION

I, JAYNE REGISTER BARKDULL, A MEMBER OF THE FLORIDA BAR, HEREBY CERTIFY THAT AS OF January 14, 2005, AT 6:00 AM

1. RECORD TITLE TO THE LAND DESCRIBED AND SHOWN ON THIS PLAT IS IN THE NAME OF THE PERSON, PERSONS, CORPORATION OR OTHER ENTITY THAT EXECUTED THE CERTIFICATE OF OWNERSHIP AND DEDICATION HEREON.
2. ALL MORTGAGES NOT SATISFIED OR RELEASED OF RECORD ENCUMBERING THE LAND DESCRIBED HEREON ARE AS FOLLOWS: NONE.
3. ALL TAXES THAT ARE DUE AND PAYABLE PURSUANT TO SECTION 197.192 F.S. HAVE BEEN PAID.

DATED THIS 11 DAY OF February 2005.

*Jayne Register Barkdull*  
JAYNE REGISTER BARKDULL, ESQ.  
LEVY KNEEN, P.L.  
1601 FORUM PLACE, SUITE 300  
WEST PALM BEACH, FLORIDA 33401  
FLORIDA BAR NO. 603759

## GENERAL NOTES

A. BEARINGS AS SHOWN HEREON ARE BASED ON FLORIDA STATE PLANE COORDINATE SYSTEM, FLORIDA EAST ZONE, NAD 83/90 AND THE SOUTH LINE OF GOVERNMENT LOT 1, SECTION 4, TOWNSHIP 39 SOUTH, RANGE 41 EAST, HAVING A BEARING OF SOUTH 89°46'19" WEST.

B. THIS PLAT, AS RECORDED IN ITS ORIGINAL FORM IN THE PUBLIC RECORDS, IS THE OFFICIAL DEPICTION OF THE SUBDIVIDED LANDS DESCRIBED HEREON AND WILL IN NO CIRCUMSTANCES BE SUPPLANTED IN AUTHORITY BY ANY OTHER FORM OF THE PLAT, WHETHER GRAPHIC OR DIGITAL.

C. THERE MAY BE ADDITIONAL RESTRICTIONS THAT ARE NOT RECORDED ON THIS PLAT THAT MAY BE FOUND IN THE PUBLIC RECORDS OF THIS COUNTY.

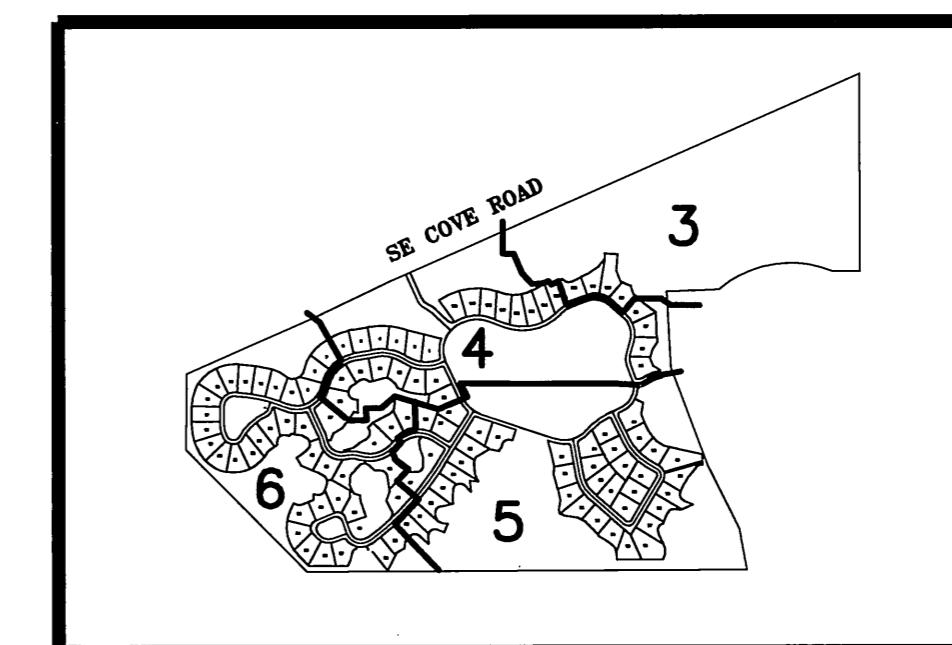

SHEET MAP

PREPARED BY:  
Gregory S. Fleming  
Professional Surveyor & Mapper  
Florida Registration No. 4350

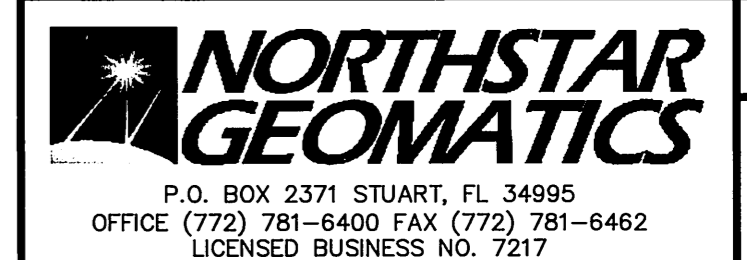

Scale  
1" = 80'  
Sheet  
2  
of  
6