

THIS IS A TRUE COPY OF THE ORIGINAL
PLAT OF RECORD OF "BLUE DIAMOND S.D."
PLAT BOOK 3, PAGE 27, ST. LUCIE COUNTY,
FLORIDA. NOW MARTIN COUNTY.

FILED IN THE CLERK'S
OFFICE, ST. LUCIE COUNTY,
FLORIDA. THIS 27 DAY
OF AUG. 1914 + RECORDED
IN PLAT BOOK 3 PAGE 27

Fred A. Stafford
REGISTERED LAND SURVEYOR
FLORIDA CERTIFICATE No. 443

J. E. Duff
CLERK
By *Eda J. Adams* D.C.

BLUE DIAMOND SUB-DIVISION
OF A PART OF THE S. 1/2 OF THE N.E. 1/4, SECTION 27
T. 37. S. R. 41. E.

SCALE 1 in = 100 FT. MAY 1914

SURVEYED BY
J.C. WAGEN
OFFICE OF
HALLOWES & WAGEN
WALTON, FLA.

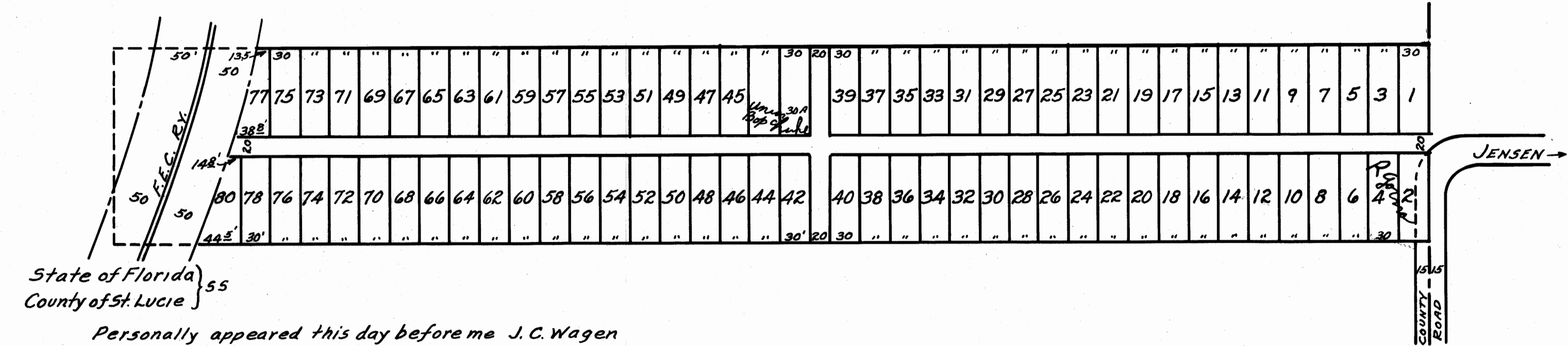
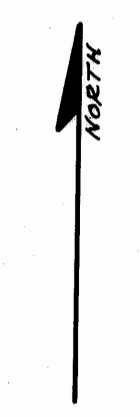

State of Florida }
County of St. Lucie } 55

Personally appeared this day before me J.C. Wagen
who, being by me first duly sworn, deposes and says that the
accompanying plat indicates and is made in accordance
with an actual survey of a part of section 27 T. 37. S. R. 41. E.

J.C. Wagen

Subscribed and sworn before me this 20th day of
May, A.D. 1914.

W. J. Harris
Notary Public State of Florida
My Commission Expires
July 15th 1916

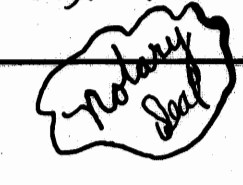

Accepted
Blue Diamond Fruit Co.
Robert L. Warren